



**MULTNOMAH COUNTY OREGON**  
**LAND USE AND TRANSPORTATION PROGRAM**  
1600 SE 190<sup>TH</sup> Avenue Portland, OR 97233  
PH: 503-988-3043 FAX: 503-988-3389  
[http://www.co.multnomah.or.us/dbcs/LUT/land\\_use](http://www.co.multnomah.or.us/dbcs/LUT/land_use)

---

**FLOODPLAIN DEVELOPMENT PERMIT**  
**CASE FILE: T1-04-015**  
**September 16, 2004**

---

**Request:** Flood Development Permit for construction of a private boat dock on the Columbia River at River Mile 101.

**Location:** 19130 NW Gillihan Road  
Tax Lot 300, Section 14A,  
T2N, R1W  
R97114-0150

**Applicant:** Leon Cieloha  
(no mailing address provided)

**Owner:** Paul Switlyk  
19130 NW Gillihan Road  
Portland, Or 97231

**Tributary:** Columbia River

**FIRM Map:** Panel #410179-0045B, dated  
3/18/1986

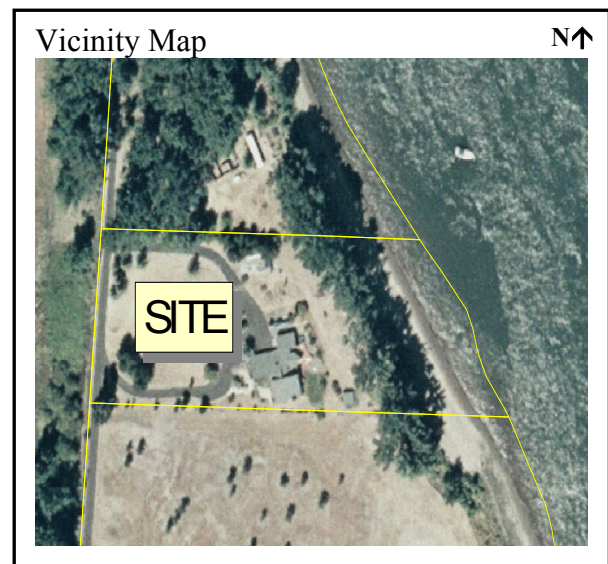

**ORDINANCE REQUIREMENTS:**

Applicable standards for this permit can be found within Chapter 29.600 et seq., Flood Hazard Regulations of the Multnomah County Building and Specialty Codes, copies of which are available at our offices.

**MODIFICATIONS AND LIMITATIONS:**

This permit is based on written narrative and plans provided by the applicant (attached). No development shall occur under this permit other than that which is specified within these documents. It shall be the responsibility of the property owner to comply with these documents and the limitations described herein. The boat dock shall be constructed in compliance with the attached application submitted April 23, 2004. **All electrical utilities must be substantially impermeable to the passage of water and located at least one foot above the base flood level (MCC 29.606(C)(1)).**

**Follow up requirements after construction:**

1. Once construction is completed, the Project Engineer shall submit a statement certifying that all work has been completed pursuant to the referenced specifications.

**Issued by:**

---

Signed: Adam Barber, Planner  
For: Karen Schilling - Planning Director

Date: September 20, 2004