



MULTNOMAH COUNTY OREGON

LAND USE AND TRANSPORTATION PROGRAM

1600 SE 190TH Avenue Portland, OR 97233

PH: 503-988-3043 FAX: 503-988-3389

http://www.co.multnomah.or.us/dbcs/LUT/land_use

GRADING AND EROSION CONTROL PERMIT

CASE FILE: T1-04-024

July 19, 2004

Request: Revised Grading and Erosion Control Permit application for grading activities associated with A new single-family dwelling, driveway, septic system and pool.

Location: 800 SE Arrow Creek
TL 3100, Sec 12, T1S, R3E, W.M.
Tax Account #R03948-1540

Applicant: Tom Orth
PO Box 2247
Gresham, OR 97030

Owner: Sham and Theresa Rockove
31310 SE Division Street
Troutdale, OR 97060

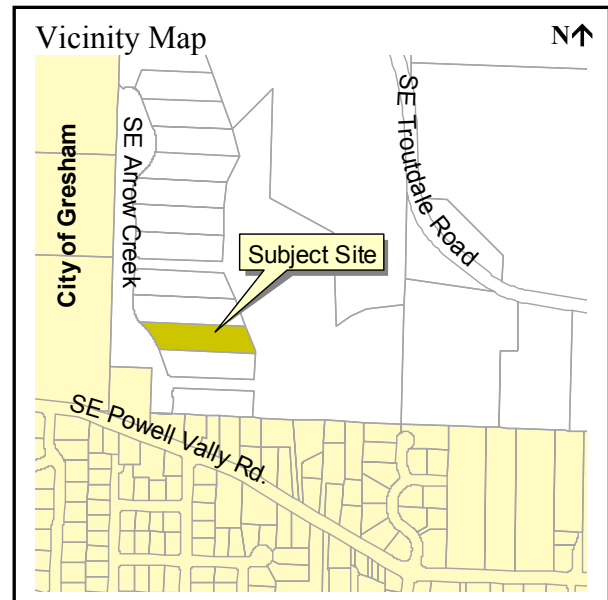

ORDINANCE REQUIREMENTS:

Applicable standards for this permit can be found in Chapter 29.320 et seq., Grading and Erosion Control Code of the Multnomah County Building and Specialty Codes, copies of which are available at our office.

MODIFICATIONS AND LIMITATIONS:

This permit is based on written narrative provided by the applicant from case #T1-04-012, the enclosed site/erosion control plan date stamped July 1, 2004, and the Drainage Certificate dated June 25, 2004. No development shall occur under this permit other than that which is specified within these documents. It shall be the responsibility of the property owner to comply with these documents and the limitations described herein.

On-going restrictions:

1. The Property Owner/Applicant shall maintain best erosion control practices through all phases of development. Erosion control measures are to include sediment fence on the downslope of all

disturbed areas, along the north property line adjacent to the sanitary sewer system capping fill, and along the southern property line adjacent to the constructed swale. Straw mulching shall be placed immediately on all exposed disturbed areas with immediate reseeding shown on the submitted site plan dated July 1, 2004. Straw mulch, erosion blankets, or 6-mil plastic sheeting shall be used as a wet weather measure to provide erosion protection for exposed soils such as the stockpile areas. All erosion control measures are to be implemented as prescribed in the current edition of the *Erosion Prevention Sediment Control Plans Technical Guidance Handbook*, copies of which are available for purchase at our office, or through the City of Portland. **The property owner or representative shall verify that all erosion control measures are properly installed and in working order prior to initiating grading activities.**

2. Fill materials for the covering of the sanitary sewer system shall be clean and non-toxic. This permit does not authorize dumping or disposal of hazardous or toxic materials, synthetics (i.e. tires), petroleum based materials, or other solid wastes which may cause adverse leachates or other off-site water quality effects.
3. The County may supplement described erosion control techniques if turbidity or other down slope erosion impacts result from on-site grading work. The Portland Building Bureau (Special Inspections Section), the local Soil and Water Conservation District, or the U.S. Soil Conservation Service can also advise or recommend measures to respond to unanticipated erosion effects.
4. The applicant/owner is responsible for removing any sedimentation caused by development activities from all neighboring surfaces and/or drainage systems.
5. On-site disposal of construction debris is not authorized under this permit. Extra spoil materials not used for re-filling shall be taken to a location approved for the disposal of such material by applicable Federal, State and local authorities.
6. Drainage of storm water run-off attributed to the dwelling and driveway shall be retained on-site adequately for up to a 10-year/24-hour storm event in the storm sewer system and swale as shown on the submitted site plan dated July 1, 2004 and certified by Ray Moore, Professional Engineer on the Drainage Certificate dated June 25, 2004.

Prior to any land disturbing activities:

7. **Before initiating grading work, the applicant/property owner shall post the attached erosion control permit notices in locations along the property that are clearly visible from the road. This notice is to remain posted until such time as the grading work is completed.** In the event this notice is lost, destroyed, or otherwise removed prior to completion of the grading work, the property owner shall immediately contact the Land Use Planning Office to obtain a suitable replacement.
8. Sediment fencing along the property lines adjacent to the work areas shall be properly installed (toed-in) prior to work beginning site disturbing activities on the property. Additional erosion control measures shall be placed and constructed as soon as practicable during all phases of construction.

Follow up requirements after grading:

9. All disturbed areas are to be seeded or planted within thirty (30) days of the date grading activities are concluded.

Issued by:

Signed: Don Kienholz, Planner
For: Karen Schilling - Planning Director

Date: Monday, July 19, 2004