



**MULTNOMAH COUNTY**  
LAND USE AND TRANSPORTATION PROGRAM  
1600 SE 190<sup>TH</sup> Avenue Portland, OR 97233  
PH: 503-988-3043 FAX: 503-988-3389  
<http://www.co.multnomah.or.us/landuse>

---

## **GRADING AND EROSION CONTROL**

### **CASE FILE: T1-06-146**

### **September 11, 2007**

---

**Request:** Grading and Erosion Control Permit for grading activities associated with the construction of a new single-family residence, and septic field.

**Location:** 16300 NW Sheltered Nook Road  
Partition Plat 2004-49, Lot 2,  
Sec 19C, T2N, R1W, W.M.  
Tax Account #R64984-1940

**Applicant/** James Zollner  
**Owner:**

### **ORDINANCE REQUIREMENTS:**

Applicable standards for this permit can be found in Chapter 29.330, Grading and Erosion Control Code of the Multnomah County Building and Specialty Codes, copies of which are available at our office.

### **MODIFICATIONS AND LIMITATIONS:**

This permit is based on written narrative(s) and plan(s), elevation certificates and construction plans provided by the applicant. No development shall occur under this permit other than that which is specified within these documents. It shall be the responsibility of the property owner to comply with these documents and the limitations described herein.

### **Prior to any land disturbing activities:**

1. When you are ready to start the grading work approved in this permit, call the Staff Planner, Don Kienholz at (503) 988-3043 extension 29270, to set up an appointment for plan check, payment of the \$77 inspection fee, and Payment of the \$53 Building Permit Review Fee. You will need to provide 2 copies of the approved erosion control plan. The permit notice card is to be posted at the driveway entrance in a clearly visible location. This notice is to remain posted until such time as the grading work is completed. In the event the notice is lost, destroyed, or otherwise removed prior to completion of the grading work, the applicant shall immediately contact the Land Use Planning office to obtain a replacement.

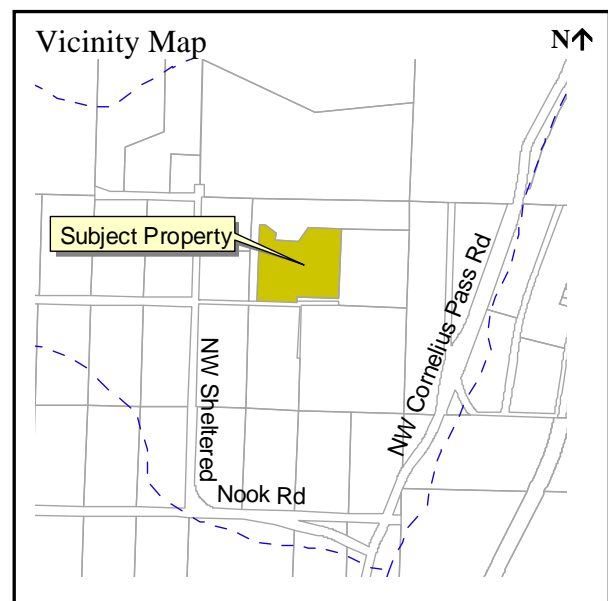

2. Sediment fencing around the development and storage areas shall be properly installed (toed-in at least 6-inches) prior to work beginning and site disturbing activities commencing on the property. Erosion control measures shall be maintained in working order until development is completed and the site stabilized.

**On-going restrictions:**

3. The Property Owner/Applicant shall maintain best erosion control practices through all phases of development. Erosion control measures are to include those discussed in the narrative submitted on February 7, 2007 (Exhibit 1) and shown on the submitted plans (Exhibit 2). In addition to those measures, wet weather erosion control measures including straw mulch, erosion blankets, or 6-mil plastic sheeting shall be placed immediately on exposed soils to provide erosion protection should a rain event occur. All erosion control measures are to be implemented as prescribed in the current edition of the *Erosion Prevention Sediment Control Plans Technical Guidance Handbook*, copies of which are available for purchase at our office, or through the City of Portland.
4. Fill materials used shall be clean and non-toxic. This permit does not authorize dumping or disposal of hazardous toxic materials, synthetics (i.e. tires), petroleum based materials, or other solid wastes which may cause adverse leachates or other off-site water quality effects.
5. The County may supplement described erosion control techniques if turbidity or other down slope erosion impacts result from on-site grading work. The Portland Building Bureau (Special Inspections Section), the local Soil and Water Conservation District, or the U.S. Soil Conservation Service can also advise or recommend measures to respond to unanticipated erosion or sedimentation effects.
6. The applicant/owner is responsible for removing any sedimentation caused by development activities from all neighboring surfaces and/or drainage systems.
7. On-site disposal of construction debris is not authorized under this permit. Extra spoil materials not used for filling shall be taken to a location approved for the disposal of such material by applicable Federal, State and local authorities.
8. Drainage of storm water run-off attributed to the structure shall be retained on-site for up to a 10-year/24-hour storm event in the existing storm sewer system to be modified as recommended by Columbia Geotechnical in the narrative by the storm sewer and detention system as described in the applicants' narrative dated May 17, 2006. A drainage certificate, attached as Exhibit 3, has been stamped by Patrick E. Wilmoth, Professional Engineer, certifying that the newly generated stormwater from the structure will be handled adequately on site for a 10-year/24-hour storm event.

**Follow up requirements after grading:**

9. All disturbed areas are to be seeded or planted within thirty (30) days of the date grading activities are concluded.

**Exhibits**

1. Applicant's Narrative
2. Site Plan
3. Stormwater Certificate

**Issued by:**

---

Signed: Don Kienholz, Planner  
For: Karen Schilling - Planning Director

Date: Tuesday, September 11, 2007