



**MULTNOMAH COUNTY**  
LAND USE AND TRANSPORTATION PROGRAM  
1600 SE 190<sup>TH</sup> Avenue Portland, OR 97233  
PH: 503-988-3043 FAX: 503-988-3389  
<http://www.co.multnomah.or.us/landuse>

---

## **GRADING AND EROSION CONTROL PERMIT**

### **CASE FILE: T1-07-012**

### **December 20, 2007**

---

**Request:** Grading and Erosion Control Permit application for grading activities associated with the following:

1. Widening of SE 282<sup>nd</sup> Avenue to accommodate protected left-turn lanes onto SE Stone Road;
2. Realignment of SE Stone Road to improve sight distance and align the east leg of the intersection with the existing west leg;
3. Replacement of a 6-ft square box culvert with a 28-ft full span bridge over Johnson Creek;
4. Related Stormwater Treatment Facilities and Culvert Replacement; and
5. Riparian & Wetland Mitigation Creation and Restoration pursuant to the land use permit, T2-07-050.

**Location:** The Intersection of 282nd & Stone Road & Adjoining Properties.

**Applicant:** Kim Peoples, Multnomah County Transportation

### **ORDINANCE REQUIREMENTS:**

Applicable standards for this permit can be found in Chapter 29.300 et seq., Grading and Erosion Control Code of the Multnomah County Building and Specialty Codes, copies of which are available at our office.

### **MODIFICATIONS AND LIMITATIONS:**

This permit is based on written narrative(s) and plan(s) provided by the applicant (attached). No development shall occur under this permit other than that which is specified within these documents. It shall be the responsibility of the property owner to comply with these documents and the limitations described herein.

### **Prior to any land disturbing activities:**

1. When you are ready to start the grading work approved in this permit, call the Staff Planner, Lisa Estrin at (503) 988-3043 extension 22597, to set up an appointment for plan check, payment of

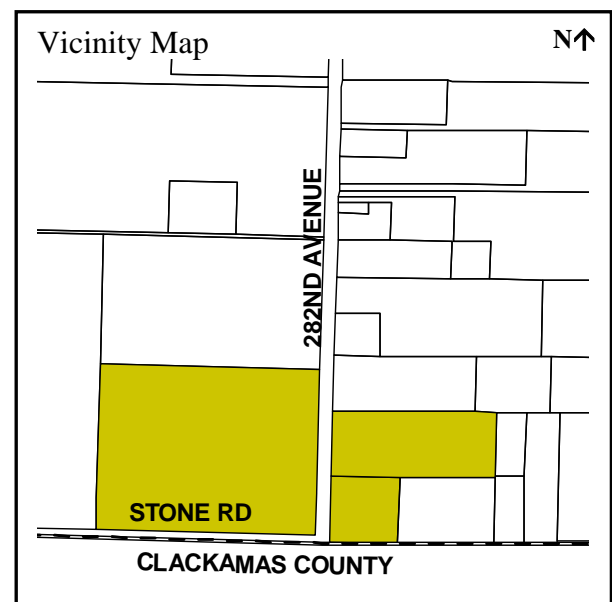

the \$77 inspection fee, and issuance of the Erosion Control Permit notice card. You will need to provide 2 copies of the approved erosion control plan.

2. The permit notice card is to be posted at each corner or work area of the project in a visible location. This notice is to remain posted until such time as the grading work is completed. In the event the notice is lost, destroyed, or otherwise removed prior to completion of the grading work, the applicant shall immediately contact the Land Use Planning office to obtain a replacement.
3. The boundary of the construction zone shall be marked with orange fencing or other restrictive materials to prevent the intrusion of construction equipment or materials into the area not to be disturbed pursuant to the SEC-wr permit, T2-07-050.
4. All erosion control measures shall be installed prior to any ground disturbing activity in each area of the project zone.

### **On-going restrictions:**

5. The Transportation Department or their representative shall maintain best erosion control practices through all phases of development. The Transportation Department shall ensure the erosion control measures shown on Sheets GA, GA-2 to GA-4 and GG are implemented. Erosion control measures shall be maintained in correct working order. All final grading shall occur by October 1, 2007 or additional wet weather measures shall be implemented. Wet weather measures are not necessary for work from October 1 to October 31<sup>st</sup> if the only work needed to be finished is final paving of the intersection and mitigation plantings.
6. The Transportation Department shall ensure post construction re-establishment of vegetative ground cover for disturbed soil and **shall verify that all erosion control measures are properly working through out the project until vegetation has been re-established.**
7. The construction project may not commence before May 1<sup>st</sup> of the year of construction of the project and shall cease by October 31<sup>st</sup> of the same year. Final plantings of the native vegetation from T2-07-050 Mitigation Report may occur the wet season and early spring if necessary for the survival of the plantings.
8. In-Water Work shall be limited to the time period of July 15<sup>th</sup> to August 31<sup>st</sup> of the year of construction.
9. All storage of gravel, earth materials, vehicles, heavy equipment and other construction materials and machinery shall be located outside of the SEC-wr overlay zone. In addition, all employee parking shall be at this staging yard. No on-site or stream-side parking of employee vehicles is permitted. During the construction of the east leg of Stone Road, the contractor may stage gravel and rip-rap materials on the closed roadway, if authorized by the Transportation Department (Multnomah or Clackamas, as appropriate) or ODOT. Any excavated soils stored within the staging area shall be covered with plastic or mulch to prevent movement into undesignated areas.
10. This permit does not authorize dumping or disposal of hazardous or toxic materials, synthetics (i.e. tires), petroleum-based materials, or other solid wastes which may cause adverse leachates or other off-site water quality effects.
11. On-site disposal of construction debris is not authorized under this permit. Construction debris removed off-site shall be taken to a location approved for the disposal of such material by applicable Federal, State and local authorities.
12. The Transportation Department is responsible for removing any sedimentation caused by

development activities from all neighboring surfaces and/or drainage systems and is responsible for returning such features to their original condition or a condition of equal quality.

13. The area of disturbance for the subject project shall be limited to the area delineated on the Plans (Exhibit 3). No other ground disturbance is authorized by this permit.
14. The Transportation Department shall verify that any disposal of earth materials excavated from the project site is to an authorized disposal site.
15. Land Use Planning or its representative may require supplement described erosion control techniques if turbidity or other down slope erosion impacts results from the project's soil disturbance. The Portland Building Bureau (Special Inspections Section), the local Soil and Water Conservation District, or the U.S. Natural Resource Conservation Service can also recommend measures to respond to unanticipated erosion events.

**Follow up requirements after grading:**

16. The Transportation Department or their contractors shall install the required vegetative plantings in accordance with the T2-07-050 mitigation report.
17. The temporary construction road gravel shall be removed upon completion of the planting shown on Sheet GA-3 (Exhibit 3.e.)

**Issued by:**

---

Signed: Lisa Estrin, Planner  
For: Karen Schilling - Planning Director

Date: Thursday, December 20, 2007

**Exhibits**

1. Grading and Erosion Control Application Form
2. Narrative Addressing GEC Standards
3. Plans
  - a. Sheet 1A to 1C: Index, Legend, and Sheet Layout
  - b. Sheets 2 to 2C: Typical Sections, Driveway Profiles, Traffic Control Plan, Pipe Data
  - c. Sheets 3 through 8B: Plans and Profiles
  - d. Sheet GA: Erosion Control Details
  - e. Sheets GA-2 to GA-4: Erosion Control Plans
  - f. Sheet GG: In-Water Work Area Isolation Plan
  - g. Sheet GJ: Stormwater Details
  - h. Sheets GJ-2 to GJ-3: Stormwater Plan and Profile
  - i. Sheets GN, GN-2: Plant Details and Planting Schedule
  - j. Sheets GN-3 to GN-5: Wetland Mitigation Plan
  - k. Sheets GN-6 to GN-10: Wetland and Riparian Mitigation Plan
  - l. Sheets 1 through 14: Bridge Drawings
  - m. Sheets ST to ST3: Sign and Striping Plan
  - n. Sheets MC: Inlet, Manhole, and General Details

4. Appendix C: Stormwater Quality and Quantity Mitigation Calculations for SE 282<sup>nd</sup> Avenue at SE Stone Road, Oregon Department of Transportation, January 9, 2007
5. Appendix D: Cut and Fill Calculations
6. Appendix E: Geotechnical Technical Memorandum, GRI Geotechnical & Environmental Consultants, September 23, 2005
7. Appendix F: ODOT Standard Drawings RD000, RD1005, RD1035, and RD1055
8. Appendix G: Certifications: Water Resource Area Certification, Advance BMP Documentation Form, Floodproofing, Stormwater, Code Compliance Memoranda
9. Appendix H: Joint Permit Application Form to US Army Corps of Engineers
10. Appendix I: National Cooperative Soils Survey Information
11. Army Corps of Engineers Authorization of Project