



## LAND USE PLANNING DIVISION

1600 SE 190<sup>th</sup> Avenue Portland, OR 97233

(503) 988-3043 FAX (503) 988-3389

<http://www.multnomah.lib.or.us/lup/home/welcome.html>

# PERMIT

## Grading and Erosion Control Application GEC 0-20

July 10, 2000

**Proposal:** Grading and fill along an existing bank, and adjacent to a new farm building.

**Location:** 9167 NW Kaiser Rd.  
TL 00800 1N1W08B  
Tax Account R96108-0070

**Property Owner /Applicant**

Gary Holman  
9167 Kaiser Rd.  
Portland, OR 97231-2702

**Zoning:** MUA-20

### VICINITY MAP

SCALE: 1" = 1,000'

N ↑

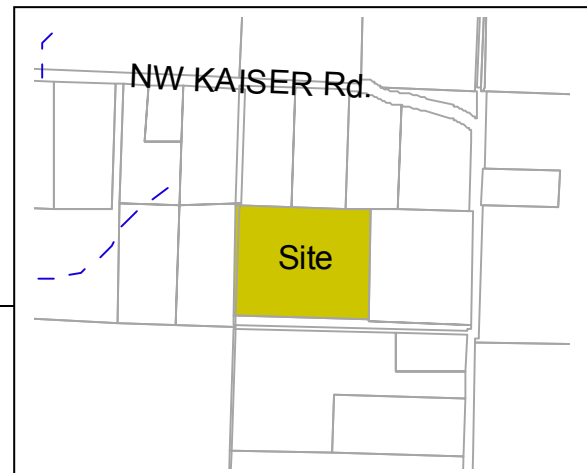

**Standards:** Chapter 29.300, Grading and Erosion Control Code of the Multnomah County Building and Specialty Codes, copies of which are available at our offices or on the County's web site listed above.

**APPROVED**, subject to limitations of work, a Grading and Erosion Control Permit for the proposed site work.

### **LIMITATIONS OF WORK GEC 0-20:**

1. This approval is based on the site plan and cross sections submitted by the applicant on 6/22/00, and the narrative submitted with the application on 5/22/00. This approval is limited to the approximate amount of imported fill indicated in these documents. No excavation or fill shall occur under this permit other than that which is specified within this permit and in these limitations of work. It shall be the responsibility of the property owner to comply with these documents and the limitations of approval described herein.
2. The property owner shall maintain best erosion control practices as described in the ***Erosion Prevention and Sediment Control Plans Technical Guidance Handbook***, through all phases of development. The Standard Notes for Erosion Control Plans apply to this permit. The applicant shall install all sediment and stormwater control devices needed to control development related disturbance prior to beginning ground disturbing activities on the site. Sediment fencing shall be installed and maintained along the downhill (southwest) edge of

the fill area. The fencing shall remain in place until a dense stand of grass has been established over the disturbed areas.

3. Fill materials shall be clean and non-toxic. This permit does not authorize dumping or disposal of hazardous or toxic materials, synthetics, petroleum based materials, or other solid wastes which may cause adverse leachates or other off-site water quality effects.
4. The property owner is responsible for removing any sedimentation caused by development activities from all neighboring surfaces and/or drainage systems. If any features within adjacent public or private right-of-way are disturbed, the property owner shall be responsible for returning such features to their original condition or a condition of equal quality.
5. The County may require supplementary erosion control techniques if turbidity or other down slope erosion impacts result from on-site grading work. The City of Portland Building Bureau, the Multnomah County Soil and Water Conservation District, or the U.S. Soil Conservation Service can also advise or recommend measures to respond to unanticipated erosion effects.
6. All disturbed areas shall be overseeded with grass as soon as possible after placement of the proposed fill.

**Note: No additional action and/or permit requests relating to this application shall be accepted until such time as all required fees for processing this decision have been paid in full.**

**The Planning Director's policy is for the case planner to provide zoning approval of the final Building Plans on an appointment basis. Please contact Chuck Beasley at 988-3043 to set a time for Building Permit sign-off.**

**IN THE MATTER OF GEC 0-20**

---

Signed: Chuck Beasley, Planner  
For: Kathy Busse, Planning Director