



MULTNOMAH COUNTY
LAND USE PLANNING DIVISION
1600 SE 190TH Avenue Portland, OR 97233
(503) 988-3043 FAX: (503) 988-3389
<http://www.multnomah.lib.or.us/lup>

GRADING AND EROSION CONTROL PERMIT

CASE FILE: GEC 0-41

November 17, 2003

Request: Grading and Erosion Control Permit application for grading activities associated with installing a new driveway to a future homesite and existing agriculture building.

Location: 750 SE Evans Road
TL 100, Sec 3, T1S, R4E, W.M.
Tax Account #R99403-0910

Applicant: Dale Burkholder
1250 NE Burnside
Gresham, OR 97030

Owner: John and Sandra Adams
6425 SE 15th Ave.
Portland, OR 97202

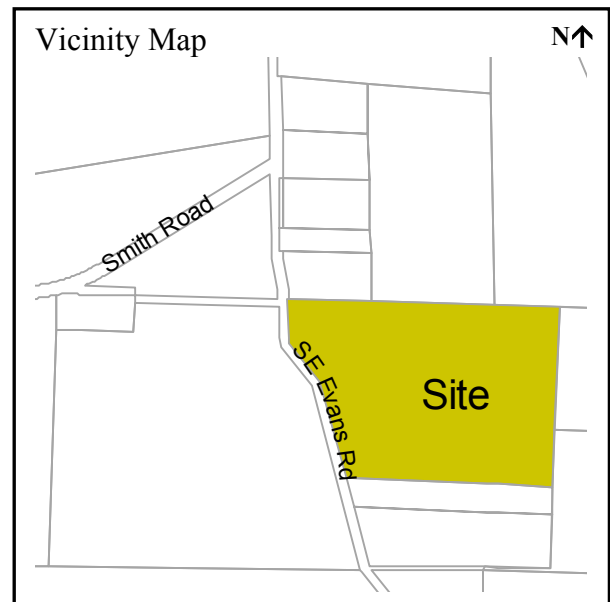

ORDINANCE REQUIREMENTS:

Applicable standards for this permit can be found in Chapter 29.300 et seq., Grading and Erosion Control Code of the Multnomah County Building and Specialty Codes, copies of which are available at our office.

MODIFICATIONS AND LIMITATIONS:

This permit is based on written narrative(s) and plan(s) provided by the applicant (attached). No development shall occur under this permit other than that which is specified within these documents. It shall be the responsibility of the property owner to comply with these documents and the limitations described herein.

On-going restrictions:

1. The property owner shall maintain best erosion control practices through all phases of development. Erosion control measures are to include the installation of sediment fences/barriers at the toe of disturbed areas and post construction re-establishment of ground cover. Straw mulch, erosion blankets, or 6-mil plastic sheeting shall be used as a wet weather measure to provide erosion protection for exposed soils. All erosion control measures are to be implemented as prescribed in the current edition of the *Erosion Prevention Sediment Control Plans Technical Guidance Handbook*, copies of which are available for purchase at our office,

our through the City of Portland. **The property owner shall verify that all erosion control measures are properly installed and in working order prior to initiating grading activities.**

2. The County may supplement described erosion control techniques if turbidity or other down slope erosion impacts result from on-site grading work. The Portland Building Bureau (Special Inspections Section), the local Soil and Water Conservation District, or the U.S. Soil Conservation Service can also advise or recommend measures to respond to unanticipated erosion effects.
3. On-site disposal of construction debris is not authorized under this permit. Spoil materials removed off-site shall be taken to a location approved for the disposal of such material by applicable Federal, State and local authorities.
4. Fill materials shall be clean and non-toxic. This permit does not authorize dumping or disposal of hazardous or toxic materials, synthetics (i.e. tires), petroleum-based materials, or other solid wastes which may cause adverse leachates or other off-site water quality effects.

Follow up requirements after grading:

1. The property owner shall contact the case planner at the Land Use Planning Division at (503) 988-3043, to arrange for a **site inspection** after the project is complete.

Grading and erosion control activities described and approved under this permit shall be completed within two (2) years from the date of this approval.

Issued by:

Signed: Don Kienholz, Planner
For: Kathy Busse, Planning Director

Date: Monday, November 17, 2003