



## Technical Memorandum

**Subject:** Filtration Facility Land Use Application Pipeline Drawings **A.2 C Civil**

**PWB Project #s:** W02229

**Date:** September 23, 2022

**To:** Dan Hogan, P.E., Project Manager  
Portland Water Bureau

**From:** Brad Phelps, P.E., Project Manager  
Jacobs



EXPIRES: 12/31/2022

**Jacobs**

The drawings attached to this technical memorandum (TM) were prepared in support of the City of Portland Water Bureau’s Bull Run Facility Pipelines land use applications in Multnomah County. These drawings were prepared under the direction of a registered professional engineer. These drawings reflect the current status of the Facility Pipelines design, which is approximately 60% complete as of the date of this TM and are considered preliminary and are not for final construction. The drawings are subject to change have been prepared and compiled for the specific purpose of addressing conformance of the project to Multnomah County land use requirements as expressed in the Multnomah County Code.

The contents of each set of drawings are listed in the tables below.

Table 1. Civil Engineering Drawings		
Drawing Number	Drawing Name	Description
LU-000	COVER SHEET	COVER SHEET
LU-503	FINISHED WATER INTERTIE STORMWATER AND UTILITY PLAN	FINISHED WATER INTERTIE STORMWATER AND UTILITY PLAN
LU-504	FINISHED WATER INTERTIE GRADING AND DRAINAGE PLAN	FINISHED WATER INTERTIE GRADING AND DRAINAGE PLAN



# Portland Water Bureau

## Bull Run Filtration Pipelines Project

LAND USE APPLICATION  
APPENDIX A.2  
C. CIVIL PLANS

SHEET NUMBER	SHEET NAME	DESCRIPTION
		FINISHED WATER INTERTIE
1	LU-000	COVERSHEET
2	LU-503	FINISHED WATER INTERTIE STORMWATER AND UTILITY PLAN
3	LU-504	FINISHED WATER INTERTIE GRADING PLAN

Exhibit A.23.a

08/22/2022 9:38:59 AM

No	Date	Description	Appd
Revision			
Survey			

**PRELIMINARY  
NOT FOR  
CONSTRUCTION**

Designed By	TWL	Program Mgr	XXX
Drawn By	AP	Const Mgr	XXX
Checked By	SDA	Const Supvr	XXX
Project Mgr	XXX	Date	6/30/22

**WARNING**  
0 1"  
If this bar does not measure 1" then the drawing is not to scale



\_\_\_\_\_  
Date  
\_\_\_\_\_  
Date



Bull Run Filtration Pipelines  
LAND USE APPLICATION  
APPENDIX A.2  
C. CIVIL PLANS  
COVERSHEET

SAP Project No  
**W02563**  
1/4 Section  
Sheet No  
LU-000

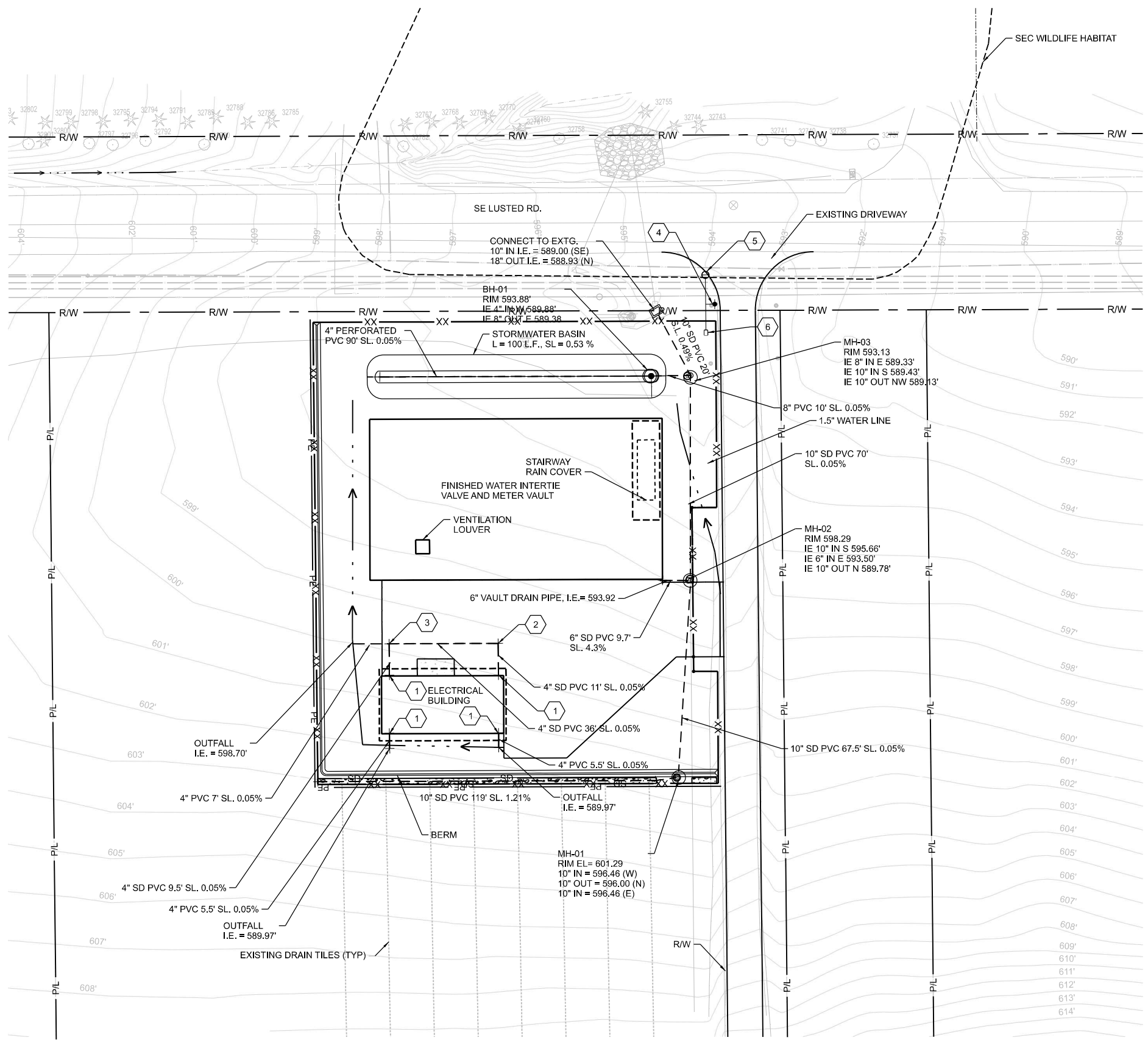

**DETAILS**

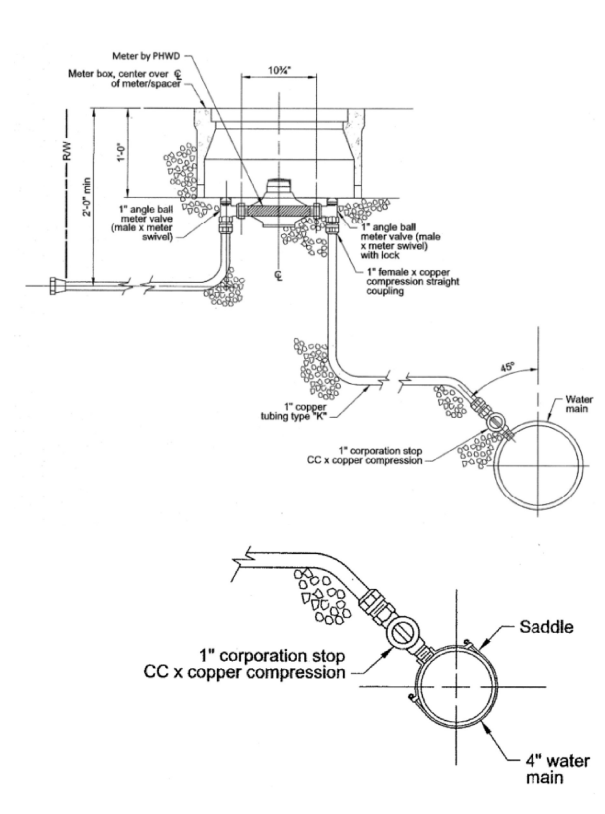
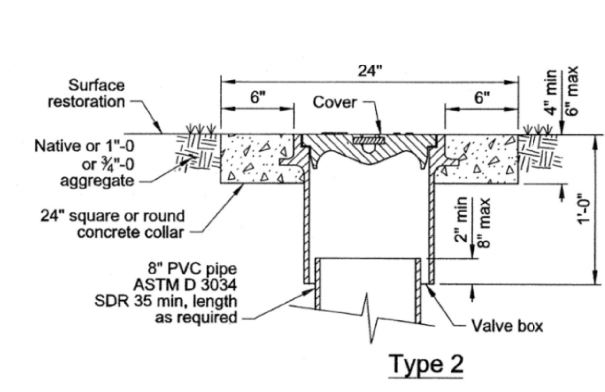
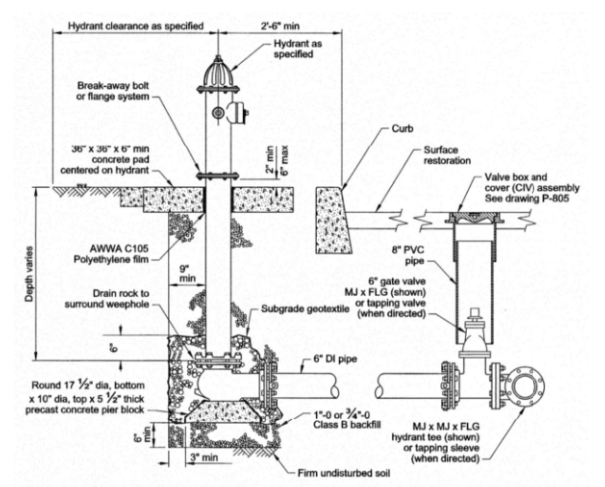

**GENERAL SHEET NOTES**

- STORMWATER  
EXISTING NURSERY FIELD DRAINAGE TILES TO BE INTERCEPTED AND BYPASSED AROUND FVI SITE TO EXISTING CATCH BASIN AT NORTHEAST CORNER.  
NEW ELECTRICAL BUILDING ROOF DRAIN DOWNSPOUTS TO BE PIPED TO ADJACENT NEW STORMWATER SWALE.  
NEW STORMWATER BASIN AT NORTH SIDE OF SITE TO CAPTURE POST-DEVELOPMENT RUN-OFF TO MEET WATER QUALITY AND WATER QUANTITY REQUIREMENTS.
- DOMESTIC WATER  
NEW DOMESTIC WATER SERVICE SUPPLIED BY PLEASANT HOME WATER DISTRICT TO SERVE NEW FIRE HYDRANT, SITE IRRIGATION, AND WASH-DOWN HOSE BIBS.
- SANITARY SEWER  
NO SANITARY SEWER OR SEPTIC SERVICE IS REQUIRED.
- GAS  
NO GAS SERVICE IS REQUIRED.

**SHEET KEYNOTES**

- CONNECT TO DOWNSPOUT
- INSTALL 4" X 4" 90 DEGREE BEND
- INSTALL 4" X 4" X 4" 90 DEGREE TEE
- INSTALL FIRE HYDRANT PER PORTLAND WATER BUREAU DETAIL P-700
- INSTALL WATER VALVE PER PORTLAND WATER BUREAU DETAIL P-805
- INSTALL 5/8" WATER METER PER DETAIL

**LEGEND**

- SEC ZONE
- ☼ CONIFEROUS TREE
- DECIDUOUS TREE
- COUNTY LINE
- P/L --- PROPERTY LINE
- R/W --- RIGHT-OF-WAY
- EL --- EXISTING EASEMENT LINE
- PE --- PROPOSED EASEMENT LINE
- DITCH
- XX --- PROPOSED FENCE

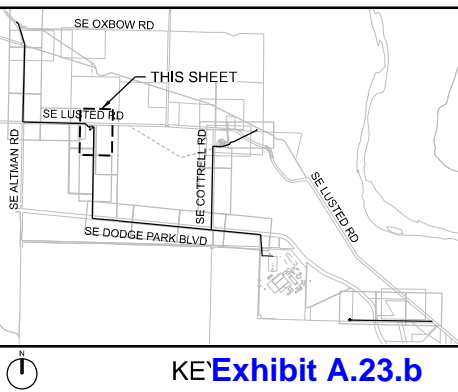
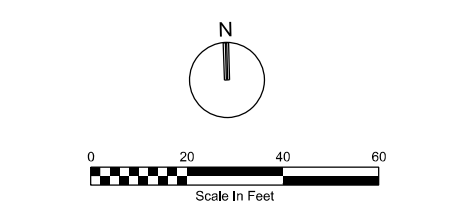

KE Exhibit A.23.b

**CONFIDENTIAL**

No	Date	Description	Appd

**PRELIMINARY  
NOT FOR  
CONSTRUCTION**

Designed By	RG	Program Mgr	XXX
Drawn By	USL	Const Mgr	XXX
Checked By	RG	Const Supvr	XXX
Project Mgr	XXX	Date	6/30/22



XXX XXX	Date
XXX XXX	Date



**Bull Run Filtration Pipelines  
FINISHED WATER INTERTIE  
STORMWATER AND UTILITY PLAN**

SAP Project No	W02563
1/4 Section	3765
Sheet No	LU-503

REUSE OF DOCUMENTS: THIS DOCUMENT, AND THE IDEAS AND DESIGNS INCORPORATED HEREIN ("DOCUMENTS"), AS AN INSTRUMENT OF PROFESSIONAL SERVICE, WAS PREPARED BY JACOBS SOLELY FOR THE PURPOSE OF THIS PROJECT AND DESIGN CRITERIA. JACOBS IS RELEASED FROM ANY AND ALL LIABILITY OF ANY KIND ARISING OUT OF OR RELATING TO THE RE-USE OF THE DOCUMENTS, IN WHOLE OR IN PART, FOR ANY OTHER PROJECT OR EXTENSIONS OF THIS PROJECT.

© JACOBS 2022. ALL RIGHTS RESERVED.

09/22/2022 5:02:34 PM W02563\_LU-503.dgn

