

Table of Contents

Introduction.....	3
<i>Capital Groups</i>	4
Capital Budget Planning and Prioritization	5
Financing Capital Projects	6
Major Capital Projects	8
<i>Replacing the Sellwood Bridge</i>	8
<i>Network Convergence</i>	9
<i>Health Department Headquarters</i>	10
<i>Downtown County Courthouse</i>	11
Capital Projects by Fund.....	12
<i>Road Fund (1501)</i>	12
<i>Road Fund (1501)</i>	13
<i>Bicycle Path Construction Fund (1503)</i>	14
<i>Willamette River Bridge Fund (1509)</i>	14
<i>Downtown Courthouse Capital Fund (2500)</i>	15
<i>Financed Projects Fund (2504)</i>	15
<i>Library Construction Fund (2506)</i>	16
<i>Capital Improvement Fund (2507)</i>	17
<i>Asset Preservation Fund (2509)</i>	20
<i>Health Department Headquarters Fund (2510)</i>	23
<i>Sellwood Bridge Replacement Fund (2511)</i>	24
<i>Information Technology Fund (3503)</i>	24



Photo Credit: Morrison Bridge by Jeff Kubina

(this page intentionally left blank)

Introduction

Multnomah County’s Capital Budget funds improvements and construction of County-owned buildings, roads, Willamette River bridges and major information technology systems. The FY 2016 budget includes \$222.7 million for capital projects, primarily for the Sellwood Bridge replacement, the new Health Department Headquarters, and a Downtown Courthouse. The below table shows routine and non-routine capital project expenditures by fund.¹ **Routine projects** maintain existing assets or are normal system-wide projects. **Non-routine projects** invest in new assets or substantially alter the function, maintenance requirements, operational costs or capacity of current assets.

1. Capital expenditures are for items or projects that have a useful life of three or more years and for which the initial costs exceed \$5,000.

Fund	Routine Projects	Non-Routine Projects	Total
Road Fund (1501)	3,655,000	4,635,000	8,290,000
Bicycle Path Construction Fund (1503)	75,000	0	75,000
Willamette River Bridge Fund (1509)	100,000	2,882,835	2,982,835
Downtown Courthouse Capital Fund (2500)	0	54,330,900	54,330,900
Financed Projects Fund (2504)	0	4,930,000	4,930,000
Library Capital Construction Fund (2506)	2,948,700	0	2,948,700
Capital Improvement Fund (2507)	15,157,368	5,166,847	20,324,215
Asset Preservation Fund (2509)	14,664,374	0	14,664,374
Health Headquarters Capital Fund (2510)	0	45,139,000	45,139,000
Sellwood Bridge Replacement Fund (2511)	0	61,615,356	61,615,356
Information Technology Fund (3503)	0	7,938,232	7,938,232
Total	\$36,600,442	\$186,638,170	\$223,238,612

The Capital Budget includes three major groups, Facilities and Property Management (FPM), Information Technology (IT) and Transportation, discussed in the next section.

Capital Groups

Facilities and Property Management (FPM) - Department of County Assets
 This group implements building construction and improvement projects. Multnomah County owns or leases over 130 facilities that include libraries, health clinics, school-based health centers, senior service centers, courthouses, correctional facilities, and office buildings. County buildings have a estimated deferred maintenance of \$25.2 million and an additional \$2.8 million in Library District deferred maintenance. The County’s estimated seismic liability is \$186.5 million and the Library District’s seismic liability is estimated at \$18.4 million.

Information Technology (IT) - Department of County Assets - This capital group is for the implementation of large scale IT projects. The Information Technology Division maintains more than 300 IT business applications operating on over 5,500 computers, laptops, and tablets.

Transportation - Department of Community Services -This group implements improvements to County-owned roads and bridges that are significant components of the regional transportation system. The County maintains roads in unincorporated areas, most in eastern Multnomah County and major roads within the East County cities of Fairview, Wood Village and Troutdale. The County is responsible for the maintenance, operation, and capital improvement of 300 miles of unincorporated County road-, bicycle- and pedestrian-ways and six Willamette River bridges. The County estimates a total of \$705.4 million seismic liability for the remaining four bridges: Broadway, Burnside, Morrison and Hawthorne.

The following table details where capital projects are budgeted.

Group	Funds	Program Offers
Facilities and Property Management	Downtown Courthouse Capital (2500)	<ul style="list-style-type: none"> • Facilities Capital Improvement Program (78007) • Facilities Capital Asset Preservation Program (78008) • Facilities Downtown Courthouse (78014) • Columbia River Boat House and Portage Building (78015) • Animal Services Renovation (78016) • Library Construction Fund (78017) • Yeon - AG Fuel Tanks Installation (78052) • Yeon Annex - Reception and Lobby Redesign (78054) • ESPC - Juvenile Justice Complex Lighting (78055) • ESPC - Inverness Jail - Water (78056) • MCSO Suicide Prevention Projects - Vent Covers (78057)
	Library Construction (2506) Capital Improvement (2507) Asset Preservation (2509) Health Department Headquarters Capital (2510)	
Information Technology	Financed Projects (2504) Information Technology (3503)	<ul style="list-style-type: none"> • DART Assessment & Taxation System Upgrade (72035) • IT Continuity of Operations (78019) • IT Innovation & Investment Projects (78020A-E) • Cyber Security (78037) • CRIMES Replacement Assessment (78058)
Transportation	Road (1501) Bicycle Path Construction (1503) Willamette River Bridge (1509) Sellwood Bridge Replacement (2511)	<ul style="list-style-type: none"> • Sellwood Bridge Replacement (91017) • Transportation Capital (91018)

Capital Budget Planning and Prioritization

The prioritization and planning methods for projects in Multnomah County's Capital Budget vary by group. The following summarizes planning and prioritization strategies by capital group:

- **Facilities and Property Management:** Staff work with departments to identify facilities needs and prioritizes projects within a five-year Capital Improvement Plan (CIP). Projects are prioritized with a scoring system that considers: safety, building condition, code requirements, condition of major systems (heating, cooling etc.), potential operational savings, work place environment impact, and potential to leverage outside funding. In FY 2015, FPM completed Phase II of the 5-25 year Facilities Asset Strategic Plan and will begin implementation in FY 2016.
- **Information Technology:** Information Technology staff work with departments to plan for and request new technology additions and improvements. Countywide requests and impacts are reviewed with the Operations Council, made up of representatives from all County departments. Prioritization of requests from individual departments is made with department leadership. When necessary, prioritization of Countywide requests is made by the Operations Council and input from department directors. In all cases, prioritization is based on the potential to reduce risks, achieve returns on investment, and/or improve customer service.
- **Land Use and Transportation:** Staff uses a twenty-year long-term Capital Improvement Plan to identify and rank transportation improvement needs for County roadways and bridges. Land Use and Transportation staff use safety, congestion relief, support of regional land use goals, the availability of project-specific funding, and community support as criteria and apply the Equity Lens to evaluate projects for inclusion in to the Capital Budget.

After prioritizing and aligning projects with long-term plans, the capital groups develop program offers for inclusion in department budget requests and when the Board holds department work sessions on the Chair's proposed budget, there is a special work session for the Capital Budget with a presentation that covers the three capital groups.

A Capital Asset Strategic Planning program (72013) has been added for FY 2016. The program forms a centralized, long range capital asset strategic planning team to coordinate the County's asset strategic planning process, create, monitor, report on a Countywide capital "master plan" with a 10 -20 year timeline and link capital planning to financial planning through integrated financial modeling.

Financing Capital Projects

Multnomah County finances capital projects through dedicated tax revenue, fees, bond proceeds, grants, and internal charges. The County largely follows a pay-as-you-go philosophy to finance capital projects, preferring dedicated taxes, fees, and internal charges to issuing debt. In some years, the County also funds capital projects with one-time-only General Fund resources and the County considers bond issuance for non-routine projects with sizeable future benefit and/or long-term cost savings potential.

Facilities and Property Management project funding comes from voter-approved General Obligation bonds, Full Faith and Credit bonds, internal services charges, one-time-only General Fund, project-specific grants and other sources. Routine facilities projects are typically financed by per-square-foot capital improvement and asset preservation fees.

IT projects are financed through internal services charges, one-time-only General Fund, and limited debt proceeds from Full Faith and Credit bonds.

Transportation project funding comes from State and County vehicle fuel taxes and vehicle registration fees, land development activity, and federal sources. Fuel taxes and vehicle registration fees are the most flexible funding, while federal and private development funds are typically project-specific.

The table on the next page summarizes the revenue for funds that contain capital projects; and delineates requirements for capital project spending from requirements for other spending in those funds.

Capital Budget

fy2016 adopted budget

Funds	Beginning Working Capital	Internal Service Reimburse	Fees, Permits & Charges	Financing Sources	Intergovernmental	Taxes	Other ^{1/}	Total Revenue	Capital Project Spending	Other Spending	Total Requirements
Road (1501)	3,155,720	259,143	70,000	0	41,330,012	6,869,500	194,000	51,878,375	8,290,000	43,588,375	51,878,375
Bicycle Path Construction (1503)	368,100	0	0	0	0	0	1,800	369,900	75,000	294,900	369,900
Willamette River Bridge (1509)	1,506,275	2,909,580	0	0	6,441,997	0	5,000	10,862,852	2,982,835	7,880,017	10,862,852
Downtown Courthouse Capital (2500)	10,780,900		0	0	5,000,000	0	38,550,000	54,330,900	54,330,900	0	54,330,900
Financed Projects (2504)	4,930,000	0	0	0	0	0	0	4,930,000	4,930,000	0	4,930,000
Library Capital Construction (2506)	1,800,000	1,148,700	0	0	0	0	0	2,948,700	2,948,700	0	2,948,700
Capital Improvement (2507)	12,790,000	3,664,778	0	0	0	0	3,869,437	20,324,215	20,324,215	0	20,324,215
Asset Preservation (2509)	8,660,000	3,508,817	0	0	0	0	2,495,557	14,664,374	14,664,374	0	14,664,374
Health Headquarters Capital (2510)	14,500,000	0	0	13,739,000	0	0	16,900,000	45,139,000	45,139,000	0	45,139,000
Sellwood Bridge Replacement (2511)	41,240,683	0	11,172,605	0	9,192,068	0	10,000	61,615,356	61,615,356	0	61,615,356
Information Technology (3503)	<u>5,273,067</u>	<u>41,896,820</u>	<u>0</u>	<u>0</u>	<u>0</u>	<u>0</u>	<u>3,512,148</u>	<u>50,682,035</u>	<u>7,938,232</u>	<u>42,743,803</u>	<u>50,682,035</u>
All Funds	\$105,004,745	\$53,387,838	\$11,242,605	\$13,739,000	\$61,964,077	\$6,869,500	\$65,537,942	\$317,745,707	\$223,238,612	\$94,507,095	\$317,745,707

1. Other Revenue includes the following General Fund cash transfers and service charges.

Major Capital Projects

Replacing the Sellwood Bridge

The Sellwood Bridge project, which began in December 2011, will replace the 88 year-old Willamette River crossing with a new bridge and interchange with Highway 43. The project cost estimate is \$307.5 million. However, challenging site conditions and unanticipated costs may increase by \$10 million. Revenue from bond sales and the Multnomah County Vehicle Registration Fee has been higher than originally forecasted and would be available if necessary. The current funding plan includes the following secured sources:

- \$164.4 million - Multnomah County Vehicle Registration Fee (\$19 per year)
- \$74.7 million - City of Portland Oregon Jobs and Transportation Act revenue
- \$35.0 million - State of Oregon Jobs and Transportation Act revenue for the Highway 43 interchange
- \$15.7 million - Previously secured funds remaining after planning phase
- \$17.7 million - Tiger III Grant awarded in January 2012

The County began the detour bridge construction in December 2011 and in January 2013 the old bridge span was moved onto new temporary piers to serve as a temporary bridge during construction of the new span. In FY 2014, work on the new permanent in-water-piers was completed. The new bridge is expected to be ready for use in early-2016, with additional work to remove the temporary bridge and finish the approach ramps continuing into 2017.

FY 2016 Budget	Total Project Cost	Estimated Operating Expenditures	Estimated Completion	Program Offer #
\$61,615,356	\$307,500,000	TBD	FY 2017	91017



Conceptual rendering of the Sellwood Bridge looking east.

Network Convergence

The County's outdated, costly and aging phone system that is no longer supported by the vendor is being replaced with Voice over Internet Protocol (VoIP) technology. The new technology is expected to reduce operating expenses with a simplified infrastructure that combines of voice, video, and data networks. As of mid FY 2015, the new technology was implemented in the majority of County sites and the FY 2016 budget supports implementation in the final three: the Downtown Courthouse, the Downtown Justice Center and the Hansen building.

FY 2016 Budget	Total Project Cost	Estimated Operating Expenditures	Estimated Completion	Program Offer #
\$1,750,000	\$7,664,000	\$490,000	FY 2016	78020B-E

Health Department Headquarters

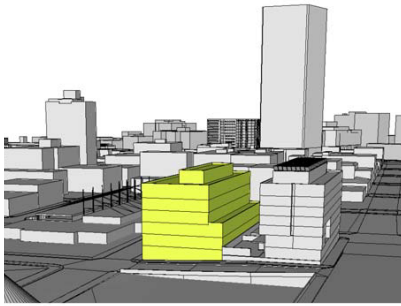

In 2011, Multnomah County and Home Forward prepared a feasibility report to relocate operations from the outdated McCoy Building on 426 S.W. Stark to a new Health Department facility on the east half of block U in downtown Portland. The McCoy facility, built in 1923, needs significant maintenance and seismic investments, and a new building is expected to better support health care personnel; the office of the Health Officer; and administrators and staff who oversee Multnomah County’s health clinics, services for children and families, and public health emergency preparedness. The new building will also house some clinic and pharmacy services. The FY 2016 budget reflects the original project estimate of \$46 million, which is currently under revision to incorporate space requirements not included in the original project scope. The FY 2016 project budget is \$45.14 million and includes:

- \$14.5 million of beginning working capital from a \$10 million Portland Development Commission (PDC) payment and prior years’ one-time-only General Fund contributions
- \$16.9 million for a second PDC payment.
- \$13.7 million from planned County financing.

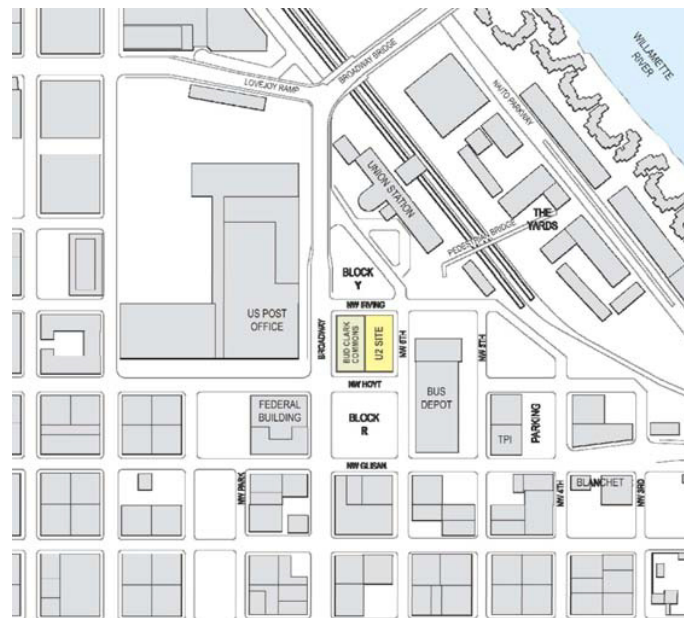

FY 2016 Budget	Total Project Cost	Estimated Operating Expenditures	Estimated Completion	Program Offer #
\$45,139,000	TBD	TBD	TBD	78018

Project still to be scoped out.

Downtown County Courthouse

The downtown Courthouse is obsolete and poses a hazard to the County in case of an earthquake. Built in 1914, the 300,000 square foot building has outlasted its useful life, is expensive to operate and is ill suited for modern courtroom and security needs. A new court facility would provide for the County's space needs, reduce maintenance costs, and increase



Photo Credit: Multnomah County Courthouse by Seth Gaines

energy efficiency. A new facility would also allow the State to meet community demand, ensure that justice is carried out in a timely manner, and support services to Multnomah County citizens. In FY 2015 a site was selected for the new building on the west end of the Hawthorne Bridge and in FY 2016 the County plans to make architect and construction manager/general contractor (CM/GC) selections, begin the project design phase and develop detailed cost estimates. The FY 2016 project budget is \$54.33 million and includes:

- \$28.12 million of FY 2016 one-time-only General Fund
- \$10.43 million from the Morrison Bridgehead sale
- \$ 9.28 million of PDC funds
- \$ 5.00 million of State match funds
- \$1.50 million of carried-over unrestricted funds from FY 2015

FY 2016 Budget	Total Project Cost	Estimated Operating Expenditures	Estimated Completion	Program Offer #
\$54,330,900	TBD	TBD	TBD	78014

Project still to be scoped out.

Capital Projects by Fund

Road Fund (1501)

The complete list of projects included in the Capital Budget are displayed here by fund under “Routine” or “Non-routine” headers. Each fund is dedicated for specific purposes as described by Board action, and projects assigned must meet the restrictions on that funding source.

Road Fund (1501) capital projects maintain and enhance the County road system. The FY 2016 program will continue preservation work with asphalt overlays on Marine Drive and slide repairs (Oxbow Park Road), pedestrian and bicycle work on NE Halsey Street, NE Arata Road and SE Troutdale Road, culvert repairs on SE Stark Street and Cochran Road (Beaver Creek), Reeder Road (Dairy Creek) on Sauvie Island, Cottrell Road and Marine Drive. Both NE Arata Road and NE Sandy Boulevard projects will move out of design and towards construction which support the cities of Fairview, Wood Village and Troutdale. These projects receive funding from State Motor Vehicle sources, County gasoline tax, permits, development fees, and federal and state grants.

Non-Routine Projects (1501)	FY 2016 Budget	Total Project Cost	Estimated Completion
Sandy Blvd Sidewalk In-fill (Right-of-Way)	35,000	120,000	FY 2016
Sandy Blvd (Walmart - 230th) Design - Construction	700,000	1,700,000	FY 2017
Arata Road Design & Construction	<u>3,900,000</u>	<u>4,468,201</u>	FY 2017
Total	\$4,635,000	\$6,288,201	

Capital Projects by Fund

Road Fund (1501)

Routine Projects (1501)	FY 2016 Budget	Total Project Cost	Estimated Completion
County Asphalt Overlays	1,250,000	1,437,500	FY 2016
ADA Ramps/Sidewalk Infill	200,000	230,000	FY 2016
Cochran Road Culvert Repair - Construction	100,000	50,000	FY 2017
Reeder Road Culvert Repair (Dairy Creek)	300,000	300,000	FY 2017
Cottrell Road Culvert Repair	300,000	360,000	FY 2016
Marine drive Culvert Repair	350,000	350,000	FY 2016
Oxbow Park Road Repair	475,000	525,000	FY 2016
Latourell Falls Bridge Replacement (Design)	30,000	30,000	FY 2018
Fish Passage Culvert Replacements	200,000	230,000	FY 2016
East County Cities A/C Overlay (IGA)	150,000	150,000	
Contingency Reserve	<u>300,000</u>	<u>300,000</u>	
Total	\$3,655,000	\$3,962,500	

Bicycle Path Construction Fund (1503)

The Bicycle Path Construction Fund (1503) receives its revenue from one percent of the County's share of motor vehicle fees, dedicated project grants and intergovernmental agreements. The fund is dedicated to the construction of bicycle and pedestrian projects. Routine projects may include bike lane striping projects or work on pedestrian crossings.

Routine Projects (1503)	FY 2016 Budget	Total Project Cost	Program Offer #
Miscellaneous Projects	\$75,000	\$75,000	91018

Willamette River Bridge Fund (1509)

The Willamette River Bridge Fund (1509) receives its revenue from gasoline tax, a portion of the County's State Motor Vehicle fee, and dedicated Federal and State project revenues, and grants. Projects in this fund are limited to the Sellwood, Hawthorne, Morrison, Burnside, Broadway, and Sauvie Island bridges.

Non-Routine Projects (1509)	FY 2016 Budget	Total Project Cost	Estimated Completion	Program Offer #
Broadway Paint Project	804,261	10,500,000	FY 2016	91018
Broadway Rall Wheel	82,160	10,000,000	FY 2017	91018
Burnside Paint/Rehab	196,414	33,000,000	FY 2018	91018
Morrison Rehabilitation	1,500,000	7,900,000	FY 2016	91018
Morrison Center Lock	<u>300,000</u>	<u>300,000</u>	FY 2016	91018
Total	\$2,882,835	\$61,700,000		

Routine Projects (1509)	FY 2016 Budget	Total Project Cost	Program Offer #
Miscellaneous Ongoing Repairs	50,000	50,000	91015
Miscellaneous Small Improvements	<u>50,000</u>	<u>50,000</u>	91015
Total	\$100,000	\$100,000	

Downtown Courthouse Capital Fund (2500)

The Downtown Courthouse Capital Fund (2500) was created solely for the Downtown Courthouse Project to account for the associated revenues and expenses. This project is discussed in the Major Projects Section.

Non-Routine Projects (2500)	FY 2016 Budget	Total Project Cost	Estimated Completion	Program Offer #
Downtown Courthouse	\$54,330,900	TBD	TBD	78014

Project still needs to be scoped out.

Financed Projects Fund (2504)

The Financed Projects Fund (2504) is for acquiring, remodeling, or constructing County facilities, information technology capital investments, and other capital projects. Funding is from Full Faith and Credit bonds or other sources including a \$1.5 million one-time-only General Fund cash transfer in FY 2015. In FY 2016, the Financed Projects Fund will continue to be dedicated to the data system replacement for the Division of Assessment, Records and Taxation (DART).

Non-Routine Projects (2504)	FY 2016 Budget	Total Project Cost	Estimated Completion	Program Offer #
DART Data System Replacement	\$4,930,000	\$5,915,857	2017	72035

Capital Budget

fy2016 adopted budget

Library Construction Fund (2506)

The Library Capital Construction Fund (2506) is for capital improvements to County libraries and was created with the FY 2015 budget to segregate capital activity for the Library District from the general government capital activity.

Routine Projects by Building (2506)	FY 2016 Budget	Total Project Cost	Estimated Completion
Central Library			
A&E Skylight Review	45,000	45,000	TBD - on hold
Refurbish 5 RTU Intellipacks	150,000	250,000	FY 2017
Replace Fire Alarm Panel/System	210,000	210,000	FY 2017
Library Administration			
Replace Boiler	370,123	430,000	FY 2016
Re-roof	378,060	383,000	FY 2016
Gregory Heights Library			
Replace Gas Packs	65,000	65,000	FY 2017
Hollywood Library			
Flooring	270,022	313,000	FY 2016
Midland Library			
Rebuild Zone Dampers	50,000	50,000	FY 2016
Rockwood Library			
Exterior and Interior Painting	52,719	60,000	FY 2016
Refurbish Roof Refurbishment	170,832	175,000	FY 2016
Woodstock Library			
Replace Flooring	200,000	200,000	FY 2017
Title Wave			
Sinkhole/Storm Water Repairs	70,000	70,000	FY 2017
Multiple Sites			
Install Alarms on Hot Water Heaters	30,000	30,000	FY 2017
Capital Roof Maint Various	65,000	65,000	FY 2017
Security Upgrades Split	80,000	200,000	FY 2019
Replace UPS 3 Sites	117,501	120,000	FY 2016
Miscellaneous Ongoing Projects	292,443	292,443	FY 2016
Emergency Expenditures FY 2016	<u>32,000</u>	<u>32,000</u>	FY 2016
Total	\$2,948,700	\$3,675,443	

Capital Improvement Fund (2507)

The Capital Improvement Fund (2507) projects are funded by a capital improvement fee assessed to County building tenants, unrestricted property sales, interest income, financing proceeds, revenue from leased facilities and one-time-only General Fund cash transfers Expenditures are made for capital projects, capital acquisitions or the retirement of lease/purchase agreements.

Non-Routine Projects (2509)	FY 2016 Budget	Total Project Cost	Estimated Completion
Water Efficiency Projects at Inverness Jail	1,496,627	1,496,627	TBD
Energy/Lighting Efficiency Projects at Juvenile Justice Complex	<u>810,000</u>	<u>810,000</u>	TBD
Total	\$2,306,627	\$2,306,627	

Routine Projects by Building (2507)	FY 2016 Budget	Total Project Cost	Estimated Completion
Hansen			
Renovate Elevator	50,000	50,000	FY 2016
Animal Services			
Replace 2 Boilers	212,390	230,000	FY 2016
Remodel Dog Kennels	306,000	306,000	FY 2016

Capital Budget

fy2016 adopted budget

Routine Projects by Building (2507)	FY 2016 Budget	Total Project Cost	Estimated Completion
Courthouse			
Replace Cooling Tower	228,220	600,000	FY 2016
Interior Finishes Upgrades	245,200	399,706	FY 2016
Main Entrance & Vestibule Door	20,000	20,000	FY 2016
Justice Center			
Court Room #1-#4 Upgrade	464,987	515,000	FY 2016
Domestic Water Piping Shared	605,000	1,778,607	FY 2016
Macerators Rebuild Preventative	100,000	100,000	FY 2016
BSER Replace AHU 2	130,000	130,000	FY 2016
Switchgear & Generator Master switch Shared	100,000	400,000	FY 2018
ELT Replace Detention Intercom & Video	325,000	325,000	FY 2017
Upgrade all DDC cabinets/Pneumatic Shared	348,000	848,000	FY 2019
Reballast/Relamp County-side	180,000	180,000	FY 2017
A&E Door System Evaluation	40,000	40,000	FY 2016
Replace Transfer Switch Shared	306,000	306,000	FY 2018
Sally Port Control System Shared	355,000	355,000	FY 2017
Waterproof Mechanic Room Shared	105,000	105,000	FY 2016
McCoy			
HVAC Repairs	193,425	300,000	FY 2016

Capital Budget

fy2016 adopted budget

Routine Projects by Building (2507)	FY 2016 Budget	Total Project Cost	Estimated Completion
Mead			
Foundation Repair	70,000	70,000	TBD
Court yard window replacement	496,780	500,000	FY 2017
Mead Lobby security entrance	195,140	200,000	FY 2016
Upgrade Elevators	250,000	250,000	FY 2016
Interior Upgrade	350,000	350,000	FY 2016
Replace Flooring 4th Fl	42,000	42,000	FY 2016
RPW - Steel Flotation 63-4			
Willamette Boathouse	564,000	623,147	FY 2016
Walnut Park			
HVAC Dental	372,640	400,000	FY 2017
Replace RTUs	500,000	500,000	FY 2017
Yeon Shops			
Add Redundant Boiler	490,455	566,418	FY 2017
Seal Shop Floor	41,000	49,525	FY 2017
Switchgear	75,000	75,000	FY 2017
Multiple Buildings			
Yeon / Vance Site analysis	127,117	137,845	TBD
Relamping And Reballasting	200,000	200,000	Mini Fund
Upgrade all DDC cabinets Tier 2	250,000	250,000	TBD
Miscellaneous Ongoing Projects	4,939,514	4,939,514	TBD
All Properties			
DMB Interest Payments thru 2017	450,000	1,350,000	FY 2017
ADA American Disabilities Act	50,000	50,000	Mini Fund
Interior Finishes	200,000	200,000	Mini Fund
BSER Building Safety Emergency Repair	500,000	500,000	Mini Fund
FLS Fire Life Safety	200,000	200,000	Mini Fund
RACC	50,000	50,000	Mini Fund
A&E Consultation for CIP	150,000	150,000	Mini Fund
Emergency Expenditures	<u>279,500</u>	<u>279,500</u>	Mini Fund
Total	\$15,157,368	\$18,921,262	

Capital Budget

fy2016 adopted budget

Asset Preservation Fund (2509)

Asset Preservation Fund (2509) projects are funded by an asset preservation fee assessed to County building tenants. The fund supports building system repairs and projects include scheduled capital maintenance such as roof replacement, boiler and chiller replacement, etc.

Non-Routine Projects (2509)	FY 2016 Budget	Total Project Cost	Estimated Completion
Water Efficiency Projects at Inverness Jail	1,496,627	1,496,627	TBD
Energy/Lighting Efficiency Projects at Juvenile Justice Complex	<u>810,000</u>	<u>810,000</u>	TBD
Total	\$2,306,627	\$2,306,627	

Routine Projects by Building (2509)	FY 2016 Budget	Total Project Cost	Estimated Completion Date
Elections			
Replace Electrical Panel boards	82,445	90,000	FY 2017
Replace Fire Alarm Panel/System	140,000	140,000	FY 2018
Remodel Restrooms & Break Room	210,000	210,000	FY 2017
Animal Services Modular Office			
Repair roof and replace siding	80,000	80,000	FY 2017
Gateway Children's Center Service Building			
Resurface Roof	100,000	100,000	FY 2017
Envelope Waterproofing	331,167	332,000	FY 2017
Inverness Jail			
Replace Exhaust Fans	120,000	120,000	FY 2018
UPS System Upgrade	300,000	300,000	FY 2016
Replacements Boiler Chiller AHU	999,215	1,520,000	FY 2017
Detention Electronics Inverness	1,871,000	2,300,000	FY 2016
Inverness Jail Laundry			
Replace Exhaust System	75,000	75,000	FY 2018

Capital Budget

fy2016 adopted budget

Routine Projects by Building (2509)	FY 2016 Budget	Total Project Cost	Estimated Completion Date
Juvenile Justice			
Upgrade Elevators	9,170	475,000	FY 2016
Fabricate Cooling Tower scaffold	29,041	29,237	FY 2016
Fire Alarm System	100,000	750,000	FY 2019
Replace Obsolete Lever Track Hardware	285,000	285,000	FY 2017
Exterior Coating	500,000	500,000	FY 2018
JJC 1st and 2nd floor TI	607,981	612,000	FY 2017
Multnomah County East			
Sealcoat Parking lot	60,000	60,000	FY 2016
Replace AHU Controls 1 2 3	60,000	60,000	FY 2018
Interior Finish Upgrades	210,000	210,000	FY 2018
Replace 2 Boilers	230,000	230,000	FY 2017
Mid-County Health			
ADA Upgrade Rest Rooms	100,000	100,000	FY 2017
North Portland Health			
Replace Awning	150,000	150,000	FY 2017
Southeast Health			
Replace Dental Lab Cabinets	64,012	65,000	FY 2016
Elevator Upgrade SEHC	150,000	150,000	FY 2018
Roof Recoating	180,000	180,000	FY 2017
The Multnomah Building			
Replace Ceiling Tiles	91,000	91,000	FY 2016
Replace VFDs	100,000	100,000	FY 2016
Replace Fire Pump	245,000	245,000	FY 2017

Capital Budget

fy2016 adopted budget

Routine Projects by Building (2509)	FY 2016 Budget	Total Project Cost	Estimated Completion Date
Multnomah Building - continued			
Replace South Cooling Tower	306,000	306,000	FY 2017
Repair and Waterproof Exterior	789,470	900,187	FY 2017
Yeon Annex			
Connect Fire Dampers to Building Automation System	70,000	70,000	FY 2016
Multiple Sites			
Replace HVAC various IT rooms	49,810	49,810	FY 2016
Install Alarms on Hot Water Heaters	50,000	50,000	FY 2017
Replace Fire Alarm system/panels	150,000	150,000	FY 2017
Upgrade all DDC cabinets Various Bldgs	250,000	750,000	TBD
Miscellaneous Ongoing Projects	2,447,528	2,447,528	FY 2016
All Properties			
RACC	30,000	30,000	Mini Fund
ADA-American Disabilities Act	50,000	50,000	Mini Fund
A&E Consultation for AP	100,000	100,000	Mini Fund
Emergency Expenditures	134,908	134,908	Mini Fund
Interior Finishes	200,000	200,000	Mini Fund
Capital Repair	<u>250,000</u>	<u>250,000</u>	Mini Fund
Total	\$12,357,747	\$15,047,670	

Health Department Headquarters Fund (2510)

The Health Department Headquarters Fund (2510) was created solely for the Health Department Headquarters project to account for the associated revenues and expenses. This project is discussed in the Major Projects Section. Project is still to be scoped out.

Non-Routine Projects (2510)	FY 2016 Budget	Total Project Cost	Estimated Completion
Health Department Headquarters	\$45,139,000	TBD	TBD

Sellwood Bridge Replacement Fund (2511)

The Sellwood Bridge Fund (2511) was created solely for the Sellwood Bridge Replacement Project to account for the associated revenues and expenses. This project is discussed in the Major Projects Section.

Non-Routine Projects (2511)	FY 2016 Budget	Total Project Cost	Estimated Completion
Sellwood Bridge Replacement	\$61,615,356	\$307,500,000	2017

Information Technology Fund (3503)

The Information Technology Fund (IT Fund) has \$6.3 million for 12 specific non-routine projects in FY 2016 as well as \$1.0 million for projects still to be selected. Please see the "Major Projects" section for a description of the Network Convergence project.

Non-Routine Projects (3503)	FY 2016 Budget	Total Project Cost	Estimated Completion
DCA Facilities Asset Mgmt	500,000	500,000	FY 2017
DCJ Document Mgmt System	263,592	540,000	FY 2016
DCA Network Convergence	1,750,000	7,664,000	FY 2016
DCA Continuity of Operations	350,000	600,000	FY 2016
DCM Budget System	239,095	1,500,000	FY 2016
DCM ERP Lifecycle	116,695	500,000	FY 2016
DCM SAP Enhancements	890,740	900,000	TBD
MCHD/DCHS/DCJ Healthcare Transformation	300,000	400,000	FY 2017
Health Inspection System	32,003	120,000	FY 2016
IT Software Replacements	1,000,000	1,000,000	TBD
IT Asset Replacement	671,107	671,107	TBD
New OTO - Cyber Security	1,725,000	1,730,000	FY 2016
New OTO Crimes Replacement Eval	<u>100,000</u>	<u>100,000</u>	FY 2016
Total	\$7,938,232	\$15,086,107	

