



Architecture - Interiors
Planning - Engineering

Portland, OR
503.224.5500
Washouak, WA
360.883.0759
Seattle, WA
206.453.9393
www.mackenzie.com

MACKENZIE

CLARK
OREGON
DEPARTMENT OF
TRANSPORTATION
9200 SW LAWFIELD
ROAD
CLACKAMAS, OR 97015

Plant
SKYLINE ROAD
STOCKPILE SITE

DATE: Issued AS Issued DATE
REVISION SCHEDULE

ALL RIGHTS RESERVED
THESE DRAWINGS ARE THE PROPERTY OF
MACKENZIE AND ARE NOT TO BE USED
WITHOUT PRIOR WRITTEN PERMISSION

SHEET TITLE
**OVERALL SITE
PLAN, PLANT
SCHEDULE AND
NOTES**

DRAWN BY: RACIADS
CHECKED BY: SPT
SHEET

L0.01
JOB NO. 2200357.00

PLANT SCHEDULE

TREES	SOIL/CLIMATE / CONTAINER PLANT	SIZE
	FRAXINUS EUROSYRIACA C-5-C-5-4 BUD CHERRY	5" CAL. B&B
	QUERCUS GARRARICA OREGON OAK	5" CAL. B&B
	BOJABUQUET / COMMUN PLANT	5" CAL. B&B
	CORNUS SERICEA 'VELUTINA' PETS / S DRUG RED FLOW DOGWOOD	2 CAL
	CALIF. HERB. SUELOW S-4-L	2 CAL
	VIOROLA JONIFLORUM OREGON GARAGE	2 CAL
	BOJABUQUET / COMMUN PLANT	4" CAL
	SEED MIX PLANTING ETC. 0-7 MIX SUNSHINE SEEDS EC DR. MIX	4 1/2" / 1000 SF
	STOP-WATER PLANTING - SEE L0.01	---
	STOP-WATER PLANTING - SEE L0.01	---
	STOP-WATER PLANTING - SEE L0.01	---

STORMWATER FACILITY PLANT SCHEDULE

PER CITY OF PORTLAND BES STORMWATER MANAGEMENT MANUAL (2020)

CATCH BASIN VEGETATION REQUIREMENTS

ZONE A VEGETATION TYPE HERBACEOUS PLANTS OR HERBACEOUS PLANTS SMALL OR LARGE SHRUBS	QUANTITY	SIZE	SPACING
HERBACEOUS PLANTS	80 / 100 SF	#1 CONTAINER	15" OC
SMALL OR LARGE SHRUBS	4 / 100 SF	#2 CONTAINER	12" OC

FACILITY A - BASIN (4,514 SF) SEE SHEET L1.11

ZONE	PLANT SPECIES	RATE	QTY	SIZE	SPACING
A (1954 SF)	HERBACEOUS PLANTS CAREX OBNOPTA / SLOUGH SEDGE JUNCUS PATENS / SPREADING RUSH SCRIPUS MICROCARPUS / SMALL FRUITED BURRUSH	80 / 100 SF (157 PLANTS) 52 #1 52 #1 53 #1	157 52 53	12" OC 12" OC 12" OC	12" OC 12" OC 12" OC
B (2540 SF)	SMALL OR LARGE SHRUBS CORNUS SERICEA 'VELUTINA' / KEISEY DOGWOOD VACCINIUM OVATUM / EVERGREEN HICKLEBERRY HEDERA HELIX / DOUGLAS SPREA SPRAEA DOUGLASII / DOUGLAS SPREA PHYSCOCARPUS CAPITATUS / PACIFIC NINEBARK VIBURNUM EDULE / HIGHBUSH CRANBERRY	7 / 100 SF (180 PLANTS) #2 #2 #2 #2 #2	180 #2 #2 #2 #2 #2	24" OC 24" OC 24" OC 24" OC 24" OC 24" OC	24" OC 24" OC 24" OC 24" OC 24" OC 24" OC
	GROUND COVER FRAGARIA CHILOENSIS / COASTAL STRAWBERRY BERBERIS REPENS / GREENING OREGON GRAPE	7 / 100 SF (180 PLANTS) #1 #1	180 #1 #1	12" OC 12" OC	12" OC 12" OC
	PLANTS REQUIRED PLANTS PROVIDED		517 PLANTS 517 PLANTS		

SHEET INDEX

L0.01	OVERALL SITE PLAN
L1.10	LANDSCAPE PLAN
L5.10	PLANT DETAILS
L5.11	IRRIGATION DETAILS

SITE INFORMATION

JURISDICTION	MULTNOMAH COUNTY
STORMWATER ZONING	RESIDENTIAL SINGLE-FAMILY
SECTION	70.222 SF
SITE AREA	1.61 AC
LANDSCAPE AREA	28,778 SF (18%)

LANDSCAPE NOTES

- CONTRACTOR SHALL CONFIRM ALL EXISTING CONDITIONS PRIOR TO COMMENCING WORK.
- CALL BEFORE YOU DIG. CONTRACTOR SHALL VERIFY INVERT ELEVATIONS OF ALL UNDERGROUND UTILITIES AND NOTIFY LANDSCAPE ARCHITECT IF THERE ARE ANY DISCREPANCIES WITH PLANTING FOOT ZONES TO REQUEST LOCATES FOR PROPOSED EXCAVATION CALL 1-800-332-3344 (OR 811) IN OREGON.
- NOTIFY THE OWNER OR OWNER'S REPRESENTATIVE OF ANY DISCREPANCIES OR CONFLICTS WITH EXISTING CONDITIONS PRIOR TO COMMENCEMENT OF ANY WORK.
- LOCATION OF EXISTING TREES SHALL BE VERIFIED IN THE FIELD BY THE CONTRACTOR PRIOR TO COMMENCEMENT OF WORK.
- DAMAGE TO EXISTING CONCRETE CURB, ASPHALT PAVING, OR OTHER STRUCTURE SHALL BE REPAIRED OR REPLACED TO PRE-CONSTRUCTION CONDITIONS.
- CONTRACTOR SHALL COORDINATE WITH THE OWNER ANY DISRUPTION TO VEHICULAR CIRCULATION PRIOR TO COMMENCEMENT OF ANY WORK.

PLANTING

- ALL EXISTING TREES, PLANTS, AND ROOTS SHALL BE PROTECTED FROM DAMAGE FROM ANY CONSTRUCTION PREPARATION, REMOVAL, OR INSTALLATION ACTIVITIES WITHIN AND ADJACENT TO PROJECT LIMITS.
- SHRUBS ADJACENT TO PARKING AREAS SHALL BE PLANTED AT A MINIMUM 10' FROM THE CURB AND 5' FROM THE SIDE OF THE DRIVE. PLANTING EDGES SHALL BE PLANTED A MINIMUM OF ONE HALF FEET FROM CENTER SPACING AWAY FROM PAVEMENT EDGE.
- ALL PLANT MATERIAL SHALL BE HEALTHY NURSERY STOCK, WELL BRANCHED AND ROOTED FULL FOLIAGE, FREE FROM INSECTS, DISEASES, WEEDS, WEED NOT INJURIES AND DEFECTS WITH NO LESS THAN MINIMUMS SPECIFIED IN AMERICAN STANDARDS FOR NURSERY STOCK. ANSI Z60.1-2004.
- IF DISTURBANCE IS NECESSARY AROUND EXISTING TREES, CONTRACTOR SHALL PROTECT THE CROWN AND ALL WORK WITHIN THE TREE DRIP ZONE SHALL BE LIMITED TO THE USE OF HAND TOOLS AND MANUAL EQUIPMENT ONLY.
- REPLACE, REPAIR AND RESTORE DISTURBED LANDSCAPE AREAS DUE TO GRADING, TRENCHING OR OTHER REASONS TO PRE-CONSTRUCTION CONDITION AND PROVIDE MATERIAL APPROVED BY THE OWNER AND OWNER'S REPRESENTATIVE.
- EXISTING AREAS PROPOSED FOR NEW PLANT MATERIAL SHALL BE CLEARED AND LEGALLY DISPOSED UNLESS SO NOTED.
- A SOIL ANALYSIS BY AN INDEPENDENT SOILS TESTING LABORATORY RECOGNIZED BY THE STATE DEPARTMENT OF AGRICULTURE SHALL BE USED TO RECOMMEND AN APPROPRIATE PLANTING SOIL, AND/OR SPECIFIED SOIL AMENDMENTS.
- TOP SOIL SHALL BE AMENDED AS RECOMMENDED BY AN INDEPENDENT SOILS TESTING LABORATORY AND AS OUTLINED IN THE SPECIFICATION.
- ALL LANDSCAPED AREAS SHALL BE COVERED BY A LAYER OF ORGANIC MULCH TO A MINIMUM DEPTH OF 2" INCHES.

IRRIGATION

- UNLESS OTHERWISE INDICATED, ALL NEW LANDSCAPE AREAS TO BE IRRIGATED WITH A FULLY AUTOMATIC UNDERGROUND IRRIGATION SYSTEM PROVIDE LOOP SYSTEM FOR OPTIMUM EFFICIENCY.
- CONTRACTOR SHALL SUBMIT SHOP DRAWINGS (IRRIGATION PLAN) TO LANDSCAPE ARCHITECT FOR REVIEW AND APPROVAL. IRRIGATION SYSTEM SHALL BE IRRIGATED PER MINUTE LATERAL LINES AND BE AT MINIMUM SCALE OF 1" = 20'.
- CONTRACTOR TO DETERMINE STATIC WATER PRESSURE AT THE P.O.C. PRIOR TO PREPARING SHOP DRAWINGS.
- CONTRACTOR SHALL ESTABLISH MINIMUM PRESSURE AND MAXIMUM DEMAND REQUIREMENTS FOR IRRIGATION SYSTEM DESIGN AND PROVIDE INFORMATION IN AN IRRIGATION SCHEDULE.
- IRRIGATION SYSTEM AS DESIGNED AND INSTALLED SHALL PERFORM WITHIN THE TOLERANCES AND SPECIFICATIONS OF THE SPECIFIED MANUFACTURERS.
- SYSTEM SHALL BE DESIGNED TO SUPPLY MANUFACTURER'S SPECIFIED MINIMUM OPERATING PRESSURE TO FARTHEST EMITTER FROM WATER METER.
- SYSTEM SHALL PROVIDE HEAD TO HEAD COVERAGE WITHOUT OVERSPRAY ONTO BUILDING, FENCES, SIDEWALKS, PARKING AREAS OR OTHER NON-VEGETATED SURFACES.
- ALL IRRIGATION PIPE MATERIAL AND INSTALLATION SHALL CONFORM TO APPLICABLE CODE FOR PIPING AND COMPONENT REQUIREMENTS.
- PROVIDE SLEEVING AT ALL AREAS WHERE PIPE TRAVELS UNDER CONCRETE OR HARD SURFACING.
- VALVES SHALL BE WARED AND INSTALLED PER MANUFACTURER'S RECOMMENDED INSTALLATION PROCEDURES AND CONNECT TO THE IRRIGATION CONTROLLER THROUGH LOW PRESSURE INFORMATION.
- REFER TO CHAL DETAIL S AND DETAIL S ON L5.11 FOR POINT OF CONNECTION AND BACKFLOW PREVENTION INFORMATION.
- COORDINATE LOCATION WITH OWNER'S REPRESENTATIVE.
- ZONE THE FOLLOWING AREAS SEPARATELY: TEMPORARY AREAS, PERMANENT LANDSCAPE AREAS AND TREES.
- QUICK COUPLERS TO BE PLACED EVERY 300 LINEAR FEET MAX.
- IRRIGATION SHALL BE WINTERIZED THROUGH LOW PRESSURE HIGH VOLUME AIR BLOWOUT CONNECTION THROUGH QUICK COUPLER.
- THE SYSTEM SHALL BE GRAVITY DRAINED. THE CONTRACTOR SHALL PROVIDE APPROPRIATE MANUAL DRAINS AT LOW POINTS.

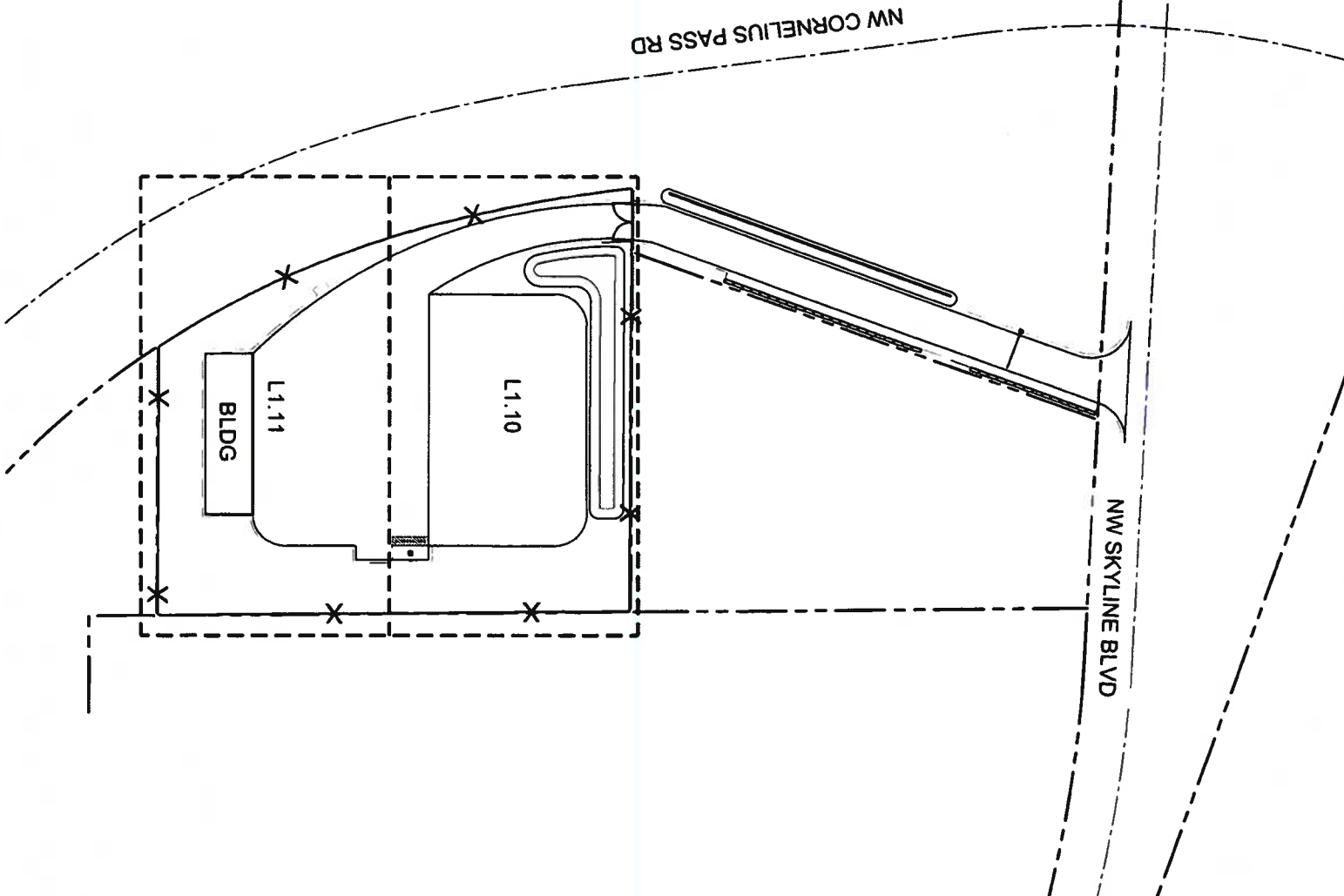

OVERALL SITE PLAN
1
1" = 50' A