

Location Map

Hot Spot: Sheltered Nook Rd

NW Cornelius Pass Road and Sheltered Nook Road



Presented Alternatives

Hot Spot: Sheltered Nook Rd

Improvement Description	Prelim. Cost Estimates
SN1: Left Turn Lane Installation	\$1.8 million
SN2: Sight Distance and Vertical Curve Improvement	\$560,000

Other Ideas

The team has received input from a variety of sources. The following idea has been heard in addition to the presented alternatives and will be considered:

- Southbound right turn lane

Input and ideas from the meeting tonight will be considered before a final recommendation is made.

Presented Alternatives

Hot Spot: Sheltered Nook Rd

SN2

Technical Detail: Intersection Sight Distance and Vertical Alignment Improvements

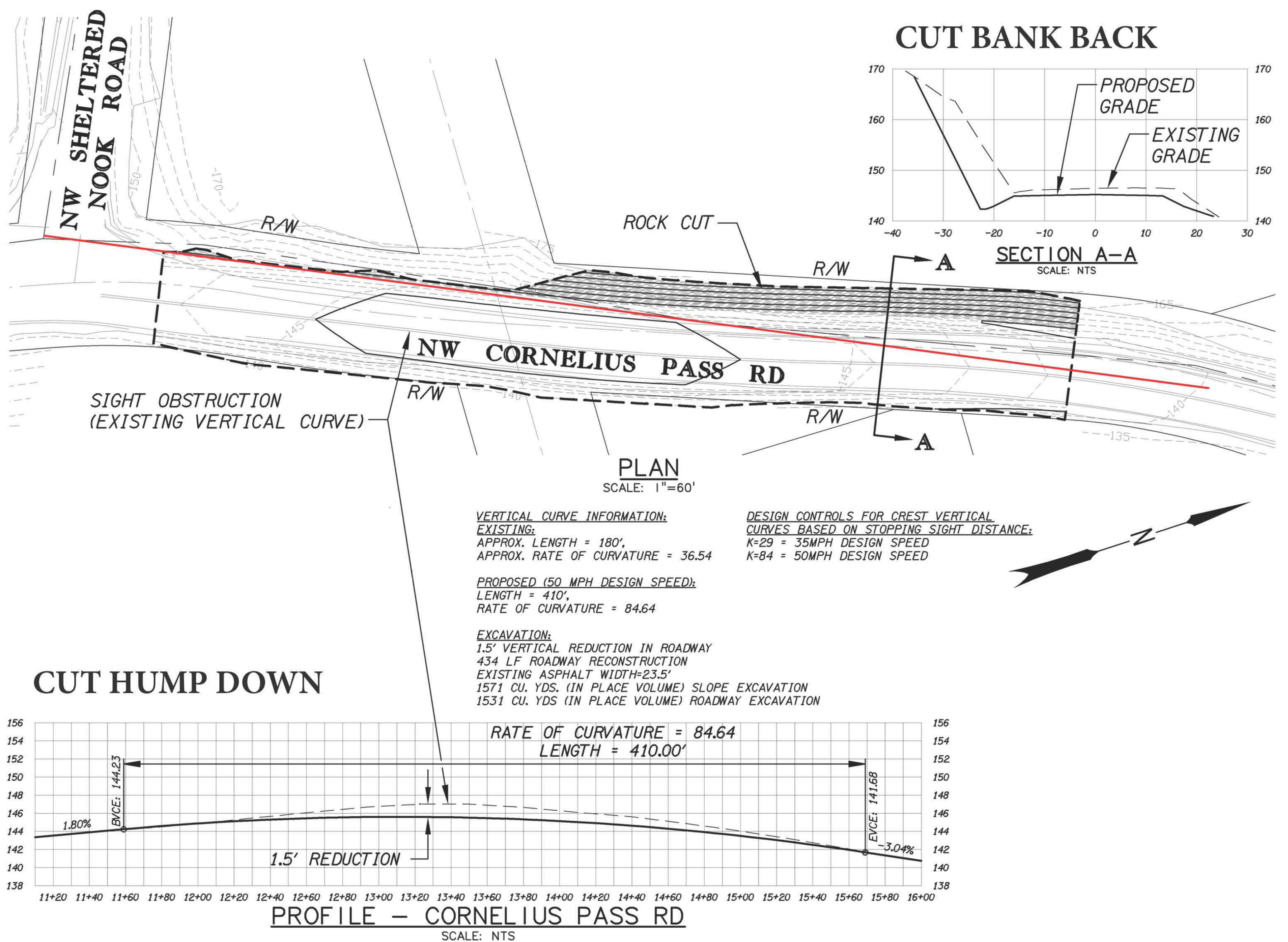

LEGEND

- PROPOSED 1 FT CONTOUR
- PROPOSED 5 FT CONTOUR
- EXCAVATION BOUNDARY
- LEFT-TURN SIGHT DISTANCE LINE OF SITE (555' NEEDED FOR 50 MPH DESIGN SPEED)