

# 14 DAY OPPORTUNITY TO COMMENT



www.multco.us/landuse ▪ Email: land.use.planning@multco.us ▪ Phone: (503) 988-3043

---

## Application for Temporary Permit

**CASE FILE:** T2-2025-0046      **APPLICANT:** Robert Fraley, Portland Water Bureau

**LOCATION:** 35320 SE Carpenter Ln, Gresham      **Property ID #** R342619 & R342603

**Map, Tax lot:** 1S4E22D-00400 & 1S4E22D-00100      **Alt. Acct. #** R994220980 & R994220820

**BASE ZONE:** Multiple Use Agriculture – 20 (MUA-20)

**OVERLAYS:** Significant Water Resources (SEC-wr), Significant Wildlife Habitat (SEC-h), Geologic Hazard (GH)

**PROPOSAL:** Request for a Temporary Permit for the placement of construction office trailers to be used during the construction of the Portland Water Bureau’s Water Filtration Facility.

---

- ❖ **COMMENT PERIOD:** Neighbors are invited to submit written comments for the proposal described above. Comments should be directed toward the approval criteria listed below. Any neighbor that submits comments will receive the County’s complete decision. Written comments will be accepted at [LUP-comments@multco.us](mailto:LUP-comments@multco.us) if received by **4:00 pm on Friday, October 17, 2025**.

**If you do not wish to submit comments, no response is necessary.**

Further information regarding this application is available by contacting [LUP-comments@multco.us](mailto:LUP-comments@multco.us). Paper copies of these materials may be purchased for \$0.71/per page.

- ❖ **APPLICABLE APPROVAL CRITERIA** [Multnomah County Code (MCC)]:

General Provisions: MCC 39.1250 Code Compliance and Applications, MCC 39.3005 Lot of Record – Generally, MCC 39.3080 Lot of Record – MUA-20, MCC 39.4315(A) Review Uses, Temporary Uses, MCC 39.4325 Dimensional Standards and Development Requirements, MCC 39.6235 Stormwater Drainage Control, MCC 39.6850 Dark Sky Lighting Standards, MCC 39.8750 Temporary Permits for Certain Uses.

Copies of the referenced Multnomah County Code sections can be obtained by visiting our website at <https://multco.us/landuse/zoning-codes/> under the link **Chapter 39 – Zoning Code** or by contacting our office at (503) 988-3043.

## Vicinity Map

N↑



- ❖ **DECISION MAKING PROCESS:** The Planning Director will render a decision on this application after the comment period expires. Notice of the Director's decision will be mailed to the applicant, parties within 750 feet of the subject property, and any other persons who submitted written comments during the comment period. The Planning Director's decision can be appealed. An explanation of the requirements for filing an appeal will be included in the notice of decision.
- ❖ **IMPORTANT NOTE:** Failure to raise an issue before the close of the public record in sufficient detail to afford the County and all parties an opportunity to respond may preclude appeal on that issue to the Land Use Board of Appeals.
- ❖ **ENCLOSURES:**
  - Site Plan

### Notice to Mortgagee, Lien Holder, Vendor, or Seller:

ORS chapter 215 requires that if you receive this notice, it must promptly be forwarded to the purchaser.



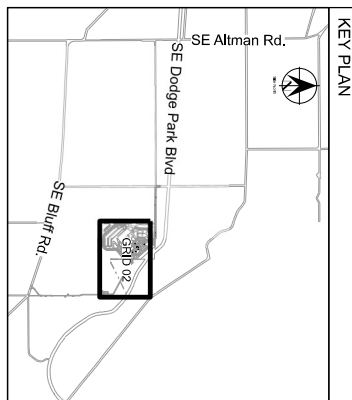
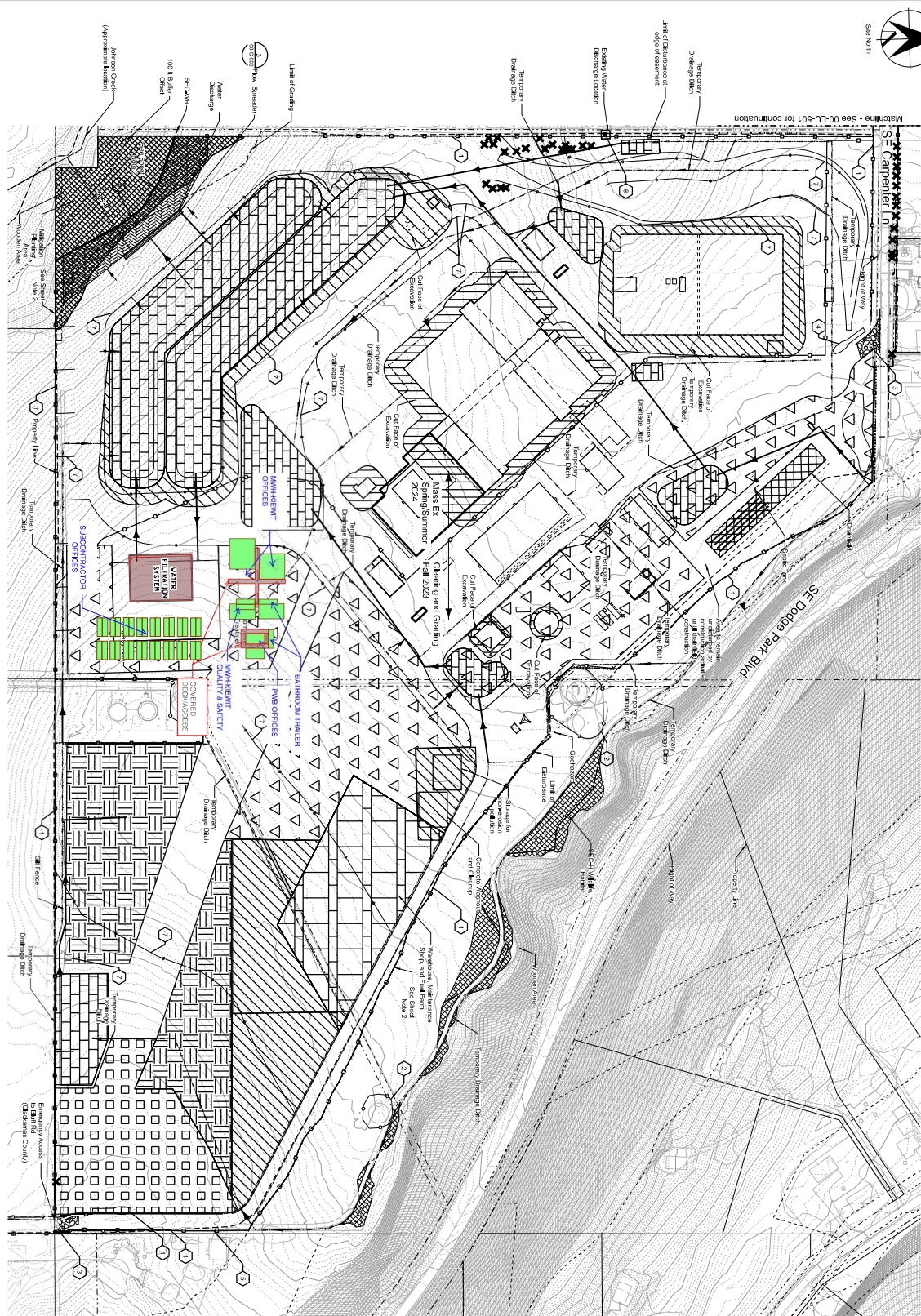

## General Sheet Notes

1. No unsupported finish slopes on site.
2. Limit of Disturbance is 1ft from Geohazard line, property line, or SEC-WR line. Temporary Sit Fence is placed at Limit of Disturbance.

## Sheet Keynotes

1. Install Temporary *Silt Fence*. See *Detail 2* on Sheet 00-C-002.
2. Install *Tree Protection Fence*. See *Detail 1* on Sheet 00-C-002.
3. Install *Subsided Construction Entrance*. See *Detail 1* on Sheet 00-C-002.
4. Install *Wheel Wash*. See *Detail 3* on Sheet 00-C-001.
5. Protect *Existing Fence*. Place *Temporary Silt Fence* minimum from existing fence.
6. Install *Compost Filter Sock*. See *Detail 2* on Sheet 00-C-003.
7. Install *Shrub Walls*. See *Detail 3* on Sheet 00-C-003.
8. Install *Water Protection*. See *Detail 2* on Sheet 00-C-002.

### Legend

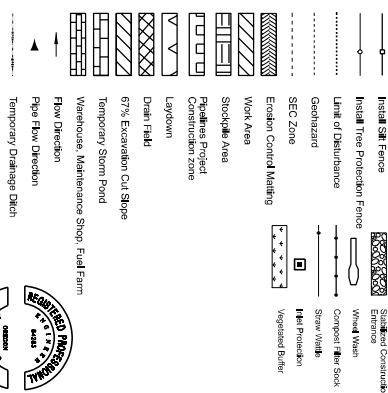

## Bull Run Filtration Facility

**Erosion and Sediment Control**  
Clearing and Construction  
Filtration Facility  
Across from 35319 SE Carpenter Lane

W02229

3765 / 3766

Sheet No  
00-C-306  
7 of 16



