



Urban Design and Aesthetics Working Group Mtg #6

*Attendees join meeting via
WebEx link in calendar invite*

Department of Community Services
Transportation Division

December 2, 2020

Meeting Protocols

Using WebEx participation features



*For WebEx tech support call or email Katy Segura:
(503) 423-3709
Katy.Segura@hdrinc.com*



Agenda

1. Welcome, Introductions, and Project Update
2. Key Project Views and Visual Elements
3. Draft Type Selection Evaluation Criteria (Homework Review)
4. Bridge Options Composition and Basic Form (Sneak Peek)
5. Next Steps and Closing Remarks



Pre-meeting Information Packet

Content

Online UDAWG Library:

<https://multco.us/earthquake-ready-burnside-bridge/urban-design-and-aesthetics-working-group>

UDAWG Meeting #6 Materials:

- UDAWG Mtg #5 Notes
- UDAWG Mtg #6 Agenda
- UDAWG Mtg #6 Presentation
- UDAWG Mtg #5 Homework Compilation (Input on Draft Type Selection Evaluation Criteria)



UDAWG Purpose and Outcome



Outcomes: To provide input on the following products for the CTF's consideration:

- ✓ Recommendations for visual and aesthetic evaluation criteria
- ✓ A project-specific Visual Design Guidelines (within notes and recommended evaluation criteria)
- A set of feasible bridge type options (next UDAWG meeting)



UDAWG Meetings

General Focus

We are HERE



	UDAWG Meeting Number and Date								
	#1 (9/30)	#2 (10/14)	#3 (10/28)	#4 (11/4)	#5 (11/18)	#6 (12/2)	#7 (12/16)	#8 (3/10)	#9 (6/2)
Character of Portland and the Burnside Bridge									
Visual Design Principles									
Visual Design Guidelines							---	2	
Technical Design Criteria									
Menu of Bridge Types									
Range of Feasible Bridge Types								1	
Evaluation Criteria Topic(s)									
Evaluation Measures							---	3	
Input on CTF's Eval Criteria									
Input on CTF's Rec Bridge Type									

Today: Type Selection Evaluation Criteria

Next Meeting: Info to CTF

- Bridge Type Input
- Type Selection Evaluation Criteria Recommendations



Key Activities

- Community Task Force (CTF) Meetings
 - **Future: Dec 7th (Discussion of Type Selection Evaluation Topics and Criteria)**
 - **Future: Dec 22nd (Recommendations for: Range of Bridge Types and Type Selection Evaluation Topics and Criteria)**
- Working / Focus Groups
 - West-side connections options (ongoing)
 - Eastbank Esplanade connection options (ongoing)





GENERAL COMMENTS

Key Project Views and Visual Elements



Key Views and Visual Elements

West Approach

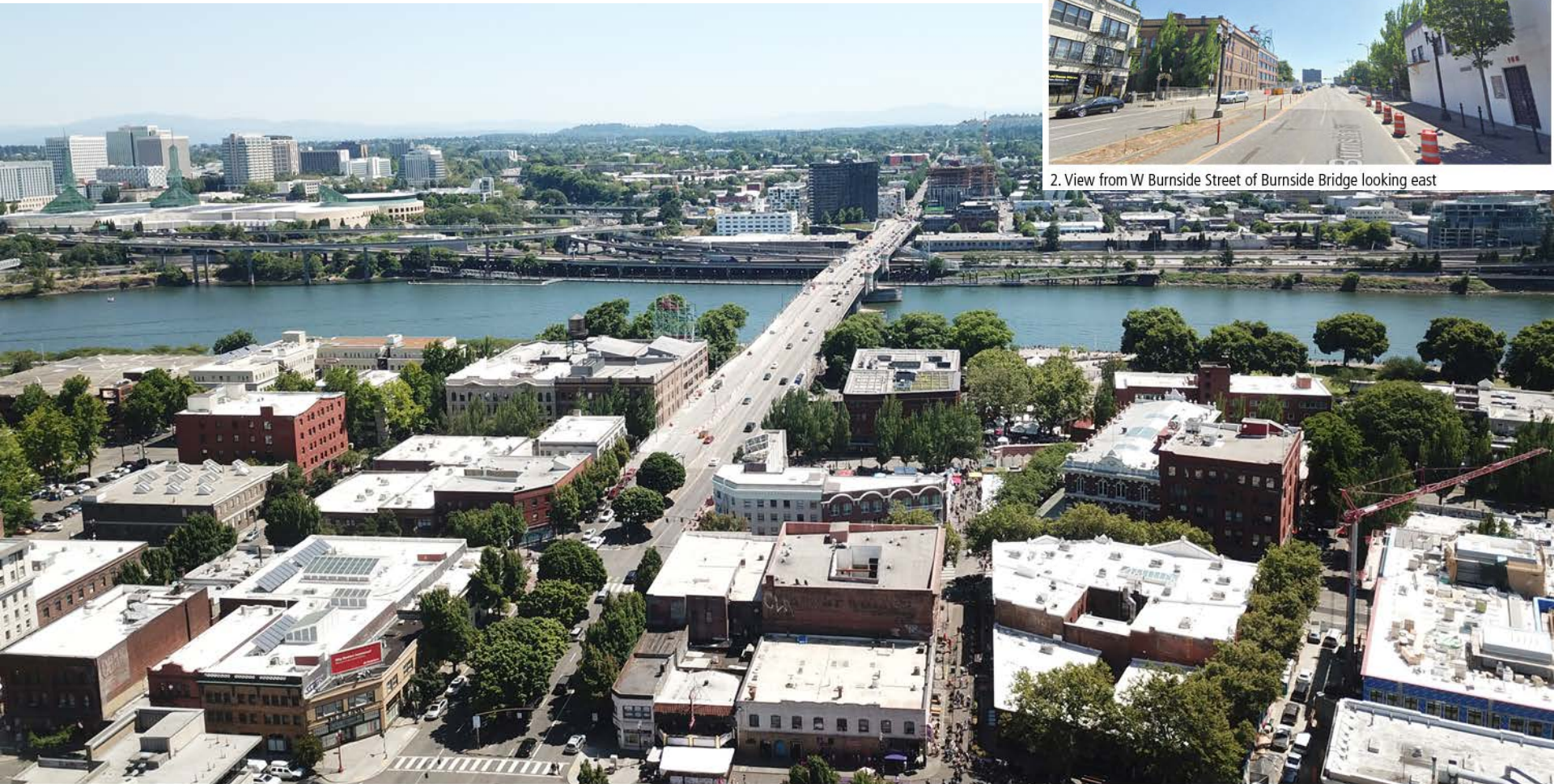

2. View from W Burnside Street of Burnside Bridge looking east

Key Views and Visual Elements

West Approach

WEST APPROACH



1. Representative building facades looking south



2. View from SW 1st MAX line looking north

Key Views and Visual Elements

West Approach

WEST APPROACH



3. Pedestrian stair at SW 1st Ave looking northeast



4. Skidmore Fountain MAX Station on 1st Ave under Burnside Bridge looking west

Source: All images from Mayer/Reed Field Visit, July 2019

Key Views and Visual Elements

West Approach



White Stag sign



Standard acorn lights and typical building facade



Old Town signs



Skidmore Fountain



Ankeny Plaza



Ornate, 3-4 story masonry buildings



Large tree canopy



Cobble paving



Light rail tracks



Key Views and Visual Elements

RIVER CROSSING



1. CCNW20: Steel Bridge - South Side (Upper Deck), Center



2. CCNW24: Greenway Trail West - At NW Couch Street



3. CCNE06: Mid-Ramp on Bike/Pedestrian Path to Steel Bridge



4. CCNE10: Duckworth Dock - South End



5. CCNE11: Burnside Bridge - North Side, Center



Key Views and Visual Elements

RIVER CROSSING



6. CCSW01: Greenway Trail West - At SW Ankeny Street



7. CCSE06: Morrison Bridge - North Side, East



8. CCSE01: Burnside Bridge - South Side, Center



9. CCSE02: Eastbank Esplanade - South of Burnside Bridge



10. CCSE03: Eastbank Esplanade - At SE Washington Street



Key Views and Visual Elements

RIVER CROSSING



11. CCSE05: Eastbank Esplanade - At SE Alder Street



12. CCNW22: Greenway Trail West - South of Steel Bridge



13. CCNW23: Greenway Trail West - Stairs Near NW Everett Street



14. CCNE04: Greenway Viewpoint at Peace Park



15. CCNE08: Eastbank Esplanade - South of Steel Bridge



Key Views and Visual Elements

River Crossing

RIVER CROSSING



4. View from Burnside Bridge looking southwest



5. View from Steel Bridge looking south



6. View from I-5 ramp looking southwest



7. View from Vera Katz Eastbank Esplanade floating walkway looking south



8. View from Vera Katz Eastbank Esplanade looking north



9. View from Morrison Bridge looking north



Key Views and Visual Elements

River Crossing

RIVER CROSSING



1. Naito Pkwy through Tom McCall Waterfront Park looking northeast



2. Japanese American Historical Plaza from Burnside Bridge looking northeast



3. Burnside Bridge from Tom McCall Waterfront Park looking north



Key Views and Visual Elements

River Crossing

RIVER CROSSING



4. Saturday Market under Burnside Bridge from Naito Pkwy looking east



5. Naito Pkwy from Burnside Bridge looking south



6. Burnside Bridge from Naito Pkwy looking south



Key Views and Visual Elements

River Crossing



7. Downtown, Old Town, and West Hills from Burnside Bridge looking west



8. Burnside Bridge deck looking east - not lifted

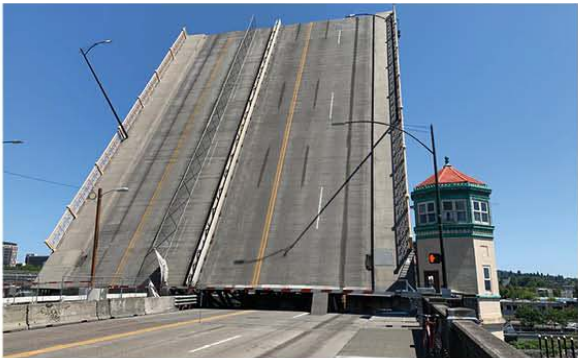

9. Burnside Bridge deck looking east - lifted

RIVER CROSSING



Key Views and Visual Elements

River Crossing



10. Burnside Bridge ornamental railing



11. Burnside Bridge under structure, looking west



12. Burnside Bridge from Willamette River looking north



Key Views and Visual Elements

River Crossing

RIVER CROSSING



13. Burnside Bridge and Downtown from Steel Bridge looking south



14. White Stag sign with Downtown and Old Town from Burnside Bridge looking west



15. Pedestrian stair to Burnside Bridge from Vera Katz Eastbank Esplanade looking east



Key Views and Visual Elements

River Crossing

RIVER CROSSING



16. Vera Katz Eastbank Esplanade floating path looking north



17. Vera Katz Eastbank Esplanade on grade path looking north

Key Views and Visual Elements

River Crossing



18. Burnside Bridge from Northbound I-5 looking north



19. Union Pacific Railroad from Burnside Bridge looking south

Key Views and Visual Elements

East Approach

EAST APPROACH



1. View from Eastside to Burnside Bridge looking west



2. View from E Burnside Street to Burnside Bridge looking west



Key Views and Visual Elements

East Approach

EAST APPROACH



1. SE 2nd Ave looking south



2. NE Couch St at NE MLK Jr Blvd looking west

Key Views and Visual Elements

East Approach



3. Under Burnside Bridge along E 3rd Ave looking west



4. Burnside Skatepark under Burnside Bridge looking east

Key Views and Visual Elements

East Approach

EAST APPROACH



Graphic facades



Large-scale residential development



Renovated warehouses



Glass facades



Active warehouses



Pedestrian and Cyclist facilities



Restricted planting space



Large-scale streets



Contemporary development



Type Selection Evaluation Criteria: Your Feedback



Type Selection Evaluation Criteria

Definitions

What are topics and criteria (interests and values) ... **Under development (now)**

- Principles or standards by which something may be judged or decided.

What are measures (information needs) ... **TBD (Future)**

- Metrics to quantify or qualitatively assess the performance or value of something relative to a given standard or principle.



Type Selection Evaluation Criteria

Guiding Principles

TBD (Future)



Measurable at the level of design and information that will be available in this step

**Under Development
(Now)**

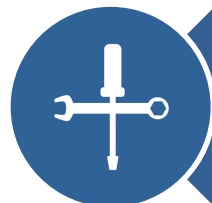

Help differentiate alternatives



Reflect input received to-date

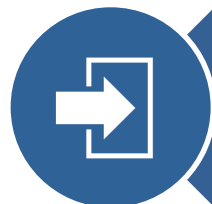

Help inform the evaluation of options and identification of a preferred bridge basic type and form



Type Selection Evaluation Criteria

Criteria Development ... Does this reflect your input?



Multnomah County is creating an earthquake-ready downtown river crossing.

November 18, 2020

DRAFT Evaluation Criteria

1 Urban Context and Experience

A. On-bridge Experience: How well does the bridge option provide public benefits from its deck surface, including:

- Views from the bridge deck towards:
 - The cityscape, including downtown and the Cascade
 - Diverse landscapes and natural environment (Mount Hood, Willamette River, Mt Hood, Mt St Helens, and open land)
 - Adjacent bridges in the up river and down river directions
- Other key viewpoints (e.g., Portland Oregon sign, Oregon Convention Center tower, Moda Center, Waterfront Park, Co Bank Tower)

B. Bridge type: How well does the bridge option provide opportunities for programming and public events (such as the Rose Festival Parade) and civic gatherings?

C. Urban Setting: How well does the bridge option's scale and form authentically fit with the scale and character of surrounding neighborhoods, buildings, parks and districts, including the:

- Old Town/Chinatown and Downtown neighborhoods, including the (Millers) / Old Town Historic District (7th & Irving)
- Tom McCall Waterfront Park and its setting (river)
- West downtown buildings and physical infrastructure (streets, roads, sidewalks, and transit)
- Kerns and Buckland neighborhoods and Central Industrial District (2500 N. Irving)
- East downtown buildings and physical infrastructure (streets, roads, sidewalks, and transit)

D. Public Use and Context: How well does the bridge option fit within park and river environments adjacent and to the bridge, including:

- Waterfront Park and its setting (river)
- West downtown buildings and physical infrastructure (streets, roads, sidewalks, and transit)
- Kerns and Buckland neighborhoods and Central Industrial District (2500 N. Irving)
- East downtown buildings and physical infrastructure (streets, roads, sidewalks, and transit)



Draft Evaluation Criteria | November 18, 2020 | Page 5



Multnomah County is creating an earthquake-ready downtown river crossing.

November 18, 2020

DRAFT Evaluation Criteria

2 Visual and Aesthetics

A. Visual Enhancement: How well does the bridge option's composition provide the perception of visual connectivity, including, but not limited to, the following:

- Visual connectivity to the cityscape, including downtown and the Cascade
- Visual connectivity to the river and surrounding landscape
- Visual connectivity to the surrounding urban environment
- Visual connectivity to the surrounding natural environment
- Visual connectivity to the surrounding infrastructure
- Visual connectivity to the surrounding public spaces
- Visual connectivity to the surrounding transportation network
- Visual connectivity to the surrounding cultural and recreational resources
- Visual connectivity to the surrounding historical and archaeological resources
- Visual connectivity to the surrounding natural resources
- Visual connectivity to the surrounding cultural and recreational resources
- Visual connectivity to the surrounding historical and archaeological resources
- Visual connectivity to the surrounding natural resources

B. Bridge Form and Style: How well does the bridge option:

- Express the Portland values and aspirations for inclusiveness, resilience, accessibility, creativity, optimism, vitality, sustainability, and freedom of expression
- Be an identifiable landmark and destination within the city
- Balance the qualities of several components, appearance and transparency (i.e., minimizing the meaning) while conveying a sense of unity, stability and reliability
- Respect the past and context while presenting a "forward thinking" design aesthetic that reflects the city's vision for future urban development and growth throughout the 20-year design life
- Reflect proportion and scale that best balances the various structural portions
- Reveal Portland's character as a "City of Bridges" and its unique location as the center of the City's growth
- Be a "City of Bridges" and its unique location as the center of the City's growth
- Be a "City of Bridges" and its unique location as the center of the City's growth

C. Bridge Materials: How well does the bridge option's materials:

- Express the Portland values and aspirations for inclusiveness, resilience, accessibility, creativity, optimism, vitality, sustainability, and freedom of expression
- Be an identifiable landmark and destination within the city
- Balance the qualities of several components, appearance and transparency (i.e., minimizing the meaning) while conveying a sense of unity, stability and reliability
- Respect the past and context while presenting a "forward thinking" design aesthetic that reflects the city's vision for future urban development and growth throughout the 20-year design life
- Reflect proportion and scale that best balances the various structural portions
- Reveal Portland's character as a "City of Bridges" and its unique location as the center of the City's growth
- Be a "City of Bridges" and its unique location as the center of the City's growth
- Be a "City of Bridges" and its unique location as the center of the City's growth

D. Bridge Lighting: How well does the bridge option's lighting:

- Express the Portland values and aspirations for inclusiveness, resilience, accessibility, creativity, optimism, vitality, sustainability, and freedom of expression
- Be an identifiable landmark and destination within the city
- Balance the qualities of several components, appearance and transparency (i.e., minimizing the meaning) while conveying a sense of unity, stability and reliability
- Respect the past and context while presenting a "forward thinking" design aesthetic that reflects the city's vision for future urban development and growth throughout the 20-year design life
- Reflect proportion and scale that best balances the various structural portions
- Reveal Portland's character as a "City of Bridges" and its unique location as the center of the City's growth
- Be a "City of Bridges" and its unique location as the center of the City's growth
- Be a "City of Bridges" and its unique location as the center of the City's growth

E. Bridge Safety: How well does the bridge option's safety:

- Express the Portland values and aspirations for inclusiveness, resilience, accessibility, creativity, optimism, vitality, sustainability, and freedom of expression
- Be an identifiable landmark and destination within the city
- Balance the qualities of several components, appearance and transparency (i.e., minimizing the meaning) while conveying a sense of unity, stability and reliability
- Respect the past and context while presenting a "forward thinking" design aesthetic that reflects the city's vision for future urban development and growth throughout the 20-year design life
- Reflect proportion and scale that best balances the various structural portions
- Reveal Portland's character as a "City of Bridges" and its unique location as the center of the City's growth
- Be a "City of Bridges" and its unique location as the center of the City's growth
- Be a "City of Bridges" and its unique location as the center of the City's growth



Draft Evaluation Criteria | November 18, 2020 | Page 6



Multnomah County is creating an earthquake-ready downtown river crossing.

November 18, 2020

DRAFT Evaluation Criteria

3 Cost

A. Total Project Cost: How well does the bridge option minimize the total project cost, including:

- Construction costs, including the influence of constructability and second-order transportation infrastructure, the Willamette River, buildings, and utilities
- Permitting and temporary right of way acquisition costs
- Utility relocation and protection costs
- The construction design phase costs
- Permitting and environmental mitigation costs
- Construction inspection and engineering support costs

B. Long Term Costs: How well does the bridge option reduce future inspection, operation, maintenance, and repair costs, including:

- Construction inspection and engineering support costs
- Permitting and temporary right of way acquisition costs
- Utility relocation and protection costs
- The construction design phase costs
- Permitting and environmental mitigation costs
- Construction inspection and engineering support costs

C. Bridge Materials: How well does the bridge option's materials:

- Express the Portland values and aspirations for inclusiveness, resilience, accessibility, creativity, optimism, vitality, sustainability, and freedom of expression
- Be an identifiable landmark and destination within the city
- Balance the qualities of several components, appearance and transparency (i.e., minimizing the meaning) while conveying a sense of unity, stability and reliability
- Respect the past and context while presenting a "forward thinking" design aesthetic that reflects the city's vision for future urban development and growth throughout the 20-year design life
- Reflect proportion and scale that best balances the various structural portions
- Reveal Portland's character as a "City of Bridges" and its unique location as the center of the City's growth
- Be a "City of Bridges" and its unique location as the center of the City's growth
- Be a "City of Bridges" and its unique location as the center of the City's growth

D. Bridge Lighting: How well does the bridge option's lighting:

- Express the Portland values and aspirations for inclusiveness, resilience, accessibility, creativity, optimism, vitality, sustainability, and freedom of expression
- Be an identifiable landmark and destination within the city
- Balance the qualities of several components, appearance and transparency (i.e., minimizing the meaning) while conveying a sense of unity, stability and reliability
- Respect the past and context while presenting a "forward thinking" design aesthetic that reflects the city's vision for future urban development and growth throughout the 20-year design life
- Reflect proportion and scale that best balances the various structural portions
- Reveal Portland's character as a "City of Bridges" and its unique location as the center of the City's growth
- Be a "City of Bridges" and its unique location as the center of the City's growth
- Be a "City of Bridges" and its unique location as the center of the City's growth

E. Bridge Safety: How well does the bridge option's safety:

- Express the Portland values and aspirations for inclusiveness, resilience, accessibility, creativity, optimism, vitality, sustainability, and freedom of expression
- Be an identifiable landmark and destination within the city
- Balance the qualities of several components, appearance and transparency (i.e., minimizing the meaning) while conveying a sense of unity, stability and reliability
- Respect the past and context while presenting a "forward thinking" design aesthetic that reflects the city's vision for future urban development and growth throughout the 20-year design life
- Reflect proportion and scale that best balances the various structural portions
- Reveal Portland's character as a "City of Bridges" and its unique location as the center of the City's growth
- Be a "City of Bridges" and its unique location as the center of the City's growth
- Be a "City of Bridges" and its unique location as the center of the City's growth



Draft Evaluation Criteria | November 18, 2020 | Page 7



Multnomah County is creating an earthquake-ready downtown river crossing.

November 18, 2020

DRAFT Evaluation Criteria

4 Construction and Operation

A. Construction Costs: How well does the bridge option minimize the total project cost, including:

- Construction costs, including the influence of constructability and second-order transportation infrastructure, the Willamette River, buildings, and utilities
- Permitting and temporary right of way acquisition costs
- Utility relocation and protection costs
- The construction design phase costs
- Permitting and environmental mitigation costs
- Construction inspection and engineering support costs

B. Long Term Costs: How well does the bridge option reduce future inspection, operation, maintenance, and repair costs, including:

- Construction inspection and engineering support costs
- Permitting and temporary right of way acquisition costs
- Utility relocation and protection costs
- The construction design phase costs
- Permitting and environmental mitigation costs
- Construction inspection and engineering support costs

C. Bridge Materials: How well does the bridge option's materials:

- Express the Portland values and aspirations for inclusiveness, resilience, accessibility, creativity, optimism, vitality, sustainability, and freedom of expression
- Be an identifiable landmark and destination within the city
- Balance the qualities of several components, appearance and transparency (i.e., minimizing the meaning) while conveying a sense of unity, stability and reliability
- Respect the past and context while presenting a "forward thinking" design aesthetic that reflects the city's vision for future urban development and growth throughout the 20-year design life
- Reflect proportion and scale that best balances the various structural portions
- Reveal Portland's character as a "City of Bridges" and its unique location as the center of the City's growth
- Be a "City of Bridges" and its unique location as the center of the City's growth
- Be a "City of Bridges" and its unique location as the center of the City's growth

D. Bridge Lighting: How well does the bridge option's lighting:

- Express the Portland values and aspirations for inclusiveness, resilience, accessibility, creativity, optimism, vitality, sustainability, and freedom of expression
- Be an identifiable landmark and destination within the city
- Balance the qualities of several components, appearance and transparency (i.e., minimizing the meaning) while conveying a sense of unity, stability and reliability
- Respect the past and context while presenting a "forward thinking" design aesthetic that reflects the city's vision for future urban development and growth throughout the 20-year design life
- Reflect proportion and scale that best balances the various structural portions
- Reveal Portland's character as a "City of Bridges" and its unique location as the center of the City's growth
- Be a "City of Bridges" and its unique location as the center of the City's growth
- Be a "City of Bridges" and its unique location as the center of the City's growth

E. Bridge Safety: How well does the bridge option's safety:

- Express the Portland values and aspirations for inclusiveness, resilience, accessibility, creativity, optimism, vitality, sustainability, and freedom of expression
- Be an identifiable landmark and destination within the city
- Balance the qualities of several components, appearance and transparency (i.e., minimizing the meaning) while conveying a sense of unity, stability and reliability
- Respect the past and context while presenting a "forward thinking" design aesthetic that reflects the city's vision for future urban development and growth throughout the 20-year design life
- Reflect proportion and scale that best balances the various structural portions
- Reveal Portland's character as a "City of Bridges" and its unique location as the center of the City's growth
- Be a "City of Bridges" and its unique location as the center of the City's growth
- Be a "City of Bridges" and its unique location as the center of the City's growth



Draft Evaluation Criteria | November 18, 2020 | Page 8



Draft Evaluation Topics and Criteria

I. Urban Context and Experience

- A. On-bridge Experience:** How well does the bridge option provide public benefits from its deck surface, including:
- Views from the bridge deck toward the cityscape, including downtown and the Eastside, distant landscapes and natural environment, adjacent up- and down-river bridges, and other key viewpoints.
 - Bridge type that provides opportunities for programming and public events (such as the Rose Festival Parade) and civic gatherings



Criteria Development

Draft Evaluation Topics and Criteria

I. Urban Context and Experience (*continued*)

- B. Urban Setting:** How well does the bridge option's scale and form authentically fit with the scale and character of surrounding neighborhoods, buildings, parks and districts, including the:
- Westside Old Town/Chinatown and Downtown neighborhoods
 - West bridgehead buildings and infrastructure shapes, scale, textures, and color
 - Eastside Kerns and Buckman neighborhoods and Central Eastside Industrial District
 - East bridgehead buildings and infrastructure shapes, scale, textures, and colors



Draft Evaluation Topics and Criteria

I. Urban Context and Experience (*continued*)

- C. Public Use and Context:** How well does the bridge option fit within park and river environments under and adjacent to the bridge, including:
- Ability to improve safety by minimizing columns, and creating adequate sightlines and clearances beneath the bridge structure
 - Ability to further activate and enhance the under-bridge space within Waterfront Park for community events and other programmed activities
 - Flexible open space and opportunity for an “urban roof” that provides public benefit
 - Integration with the Japanese American Memorial Plaza, Ankeny Plaza, Bill Naito Legacy Fountain, and Better Naito Forever, and Vera Katz Eastbank Esplanade
 - Compatibility with the varied Willamette River uses, water-surface variability, and reflectiveness on the river surface
 - Compatibility with the Burnside Skate Park and local streetscape on the East side
 - Attractive under-bridge design consideration, including lighting, materials, and detailing



Draft Evaluation Topics and Criteria

II. Visual and Aesthetics

- A. Visual Coherence:** How well does the bridge option's composition provide the perception of visual balance, unity, and flow from key viewpoints, including: Willamette River, Waterfront Park, Eastbank Esplanade, I-5 / I-84 users, Bridgehead buildings, high-rise buildings, and surrounding bridges.



Draft Evaluation Topics and Criteria

II. Visual and Aesthetics *(continued)*

B. **Bridge Form and Style:** How well does the bridge option:

- Express the Portland values and aspirations for inclusiveness, resiliency, accessibility, creativity, optimism, vitality, sustainability, and freedom of expression
- Become an identifiable landmark and destination within the city
- Balance the overall composition, qualities of openness and transparency (i.e., minimizing the massings) while conveying a sense of seismic stability and reliability
- Respect the past and context while presenting a “forward-thinking” design aesthetic that sets the tone for future urban development and growth throughout its 100-year design life
- Reflect proportions and scale that feel balanced among the various structural portions
- Honor Portland’s moniker as a “City of Bridges” and its unique location as the center of the City quadrants
- Reflect Portland’s transportation values in bicycle and pedestrian safety and accessibility



Draft Evaluation Topics and Criteria

II. Visual and Aesthetics (*continued*)

C. **Bridge Aspirations:** How well does the bridge option enable opportunities for:

- Memorable, distinctive lighting for nighttime viewing
- Creation of a gateway and enhanced sense of arrival to and from each side of the river
- Technologies that represent the era in which the bridge is designed, including the potential for exposing the movable bridge mechanisms
- Tactile, human/pedestrian-scale features within its public spaces, including overlooks
- Adapting to future bridge use or under-bridge use changes
- A range of complementary design elements (e.g., Operator's House, Multi-use path Connections, Streetcar features, overlooks, etc) to be selected during the Final Design phase



Bridge Options Composition and Basic Form (Sneak Peek)



Overall Composition

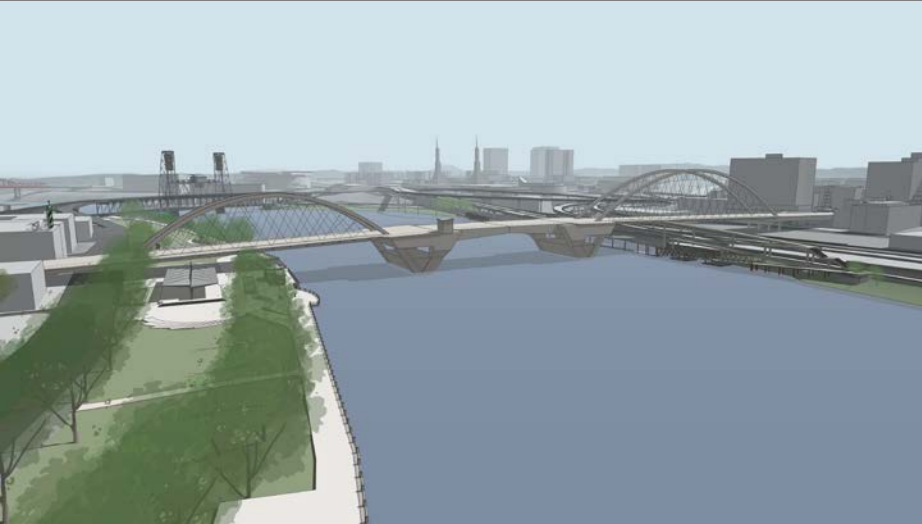

Overall Composition



Waterfront Park View



Waterfront Park View

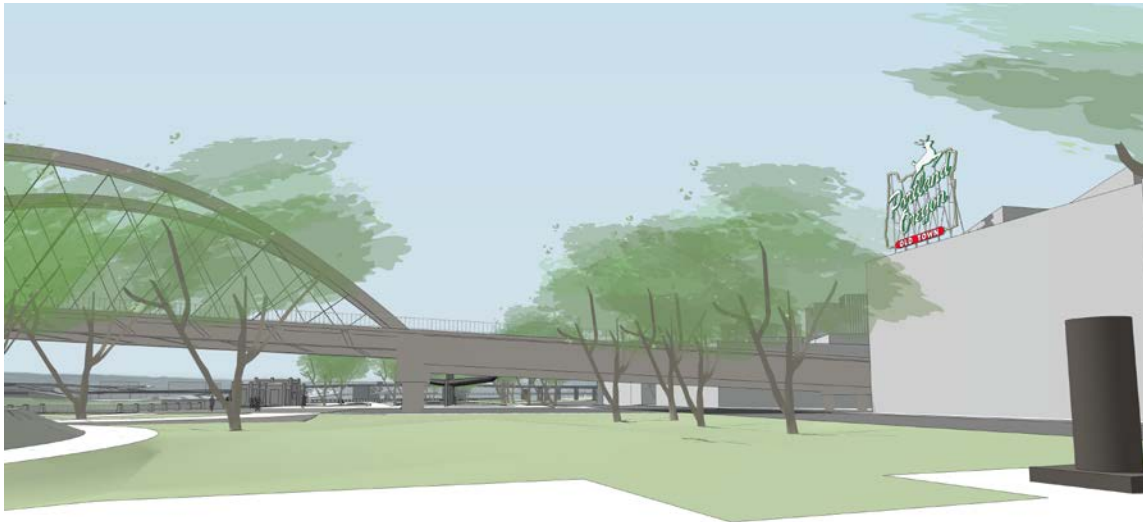
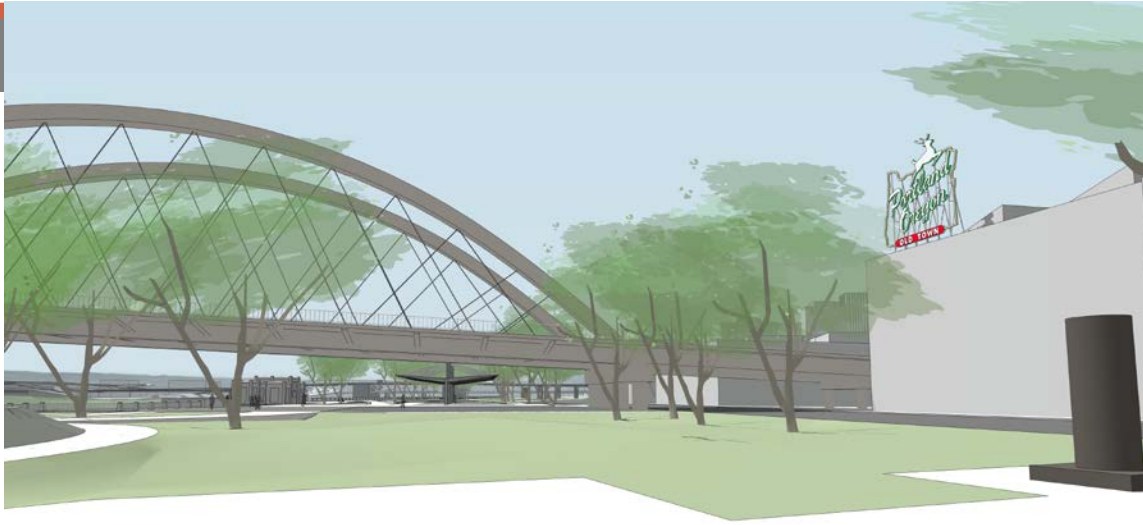

Waterfront Park View



Proposed Meeting Sequence

Proposed Meeting Dates and Durations:

- **Mtg #7 (3-4 hrs?) – Wed 12/16/20 (Comprehensive Bridge Composition; Input and Recommendations to CTF)**
 - Key Topics: Input on the Range of Feasible Alternatives; Recommended Type Selection Evaluation Criteria

----- Planned Break until March, 2021 or add another meeting in January, '21 -----

- Mtg #8 (2 hrs) – Wed 3/10/21
- Mtg #9 (2 hrs) – Wed 6/2/21





GENERAL COMMENTS

Thank you!

